

OUTLINE DRAWING

CODE: D14373 Rev.:00

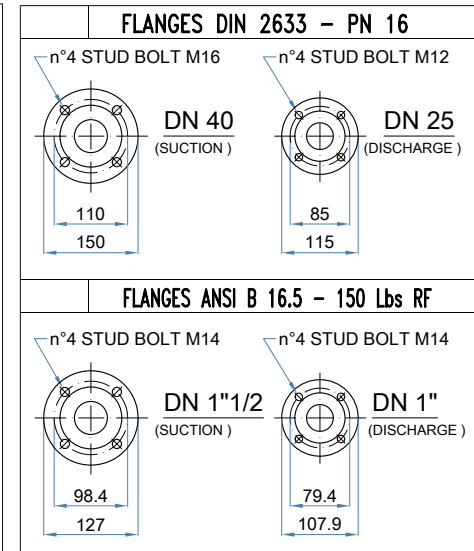
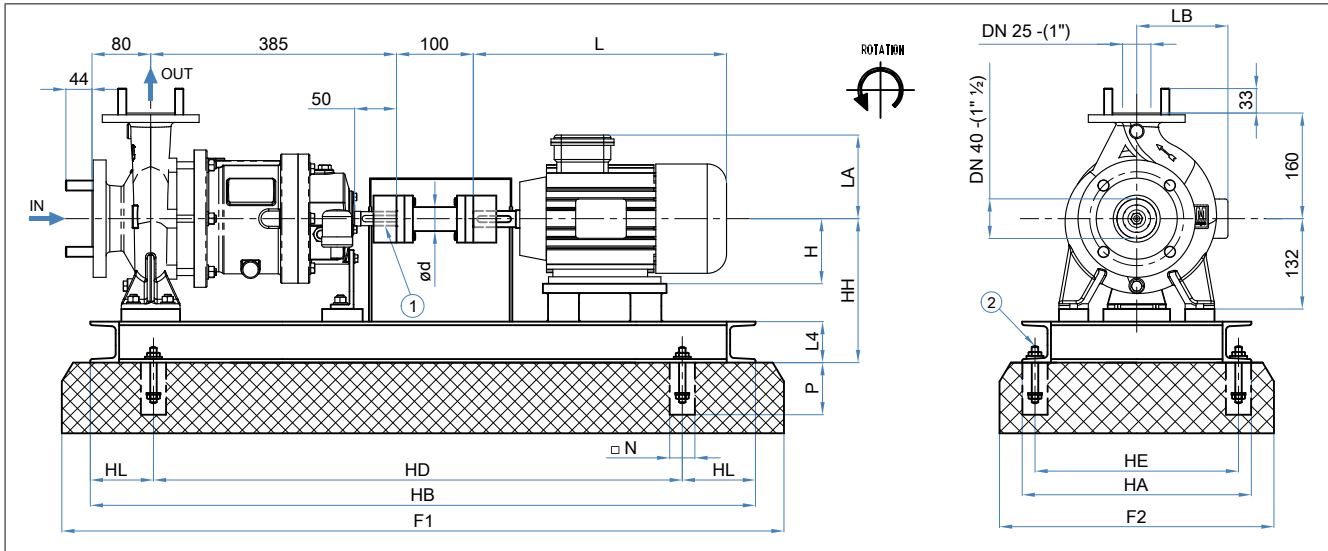

PART. 1		PART. 2		FOOT PRINT SKETCH	PUMP LUBRICATION		WEIGHT (kg)	
DIN	ANSI					STANDARD	Pump : 45	Joint : 5
			ANCHOR BOLT	OPTIONAL		OIL EXXON TERESSO quantity 50 cc - Interval 3000 hours	JOINT	RU-STEEL AD 31-100

MOTOR	MAX. (Kw)		SHAFT ø d	DIMENSIONS				BASE PLATE N°	BASEPLATE (mm)								FOUNDATION (mm)				BOLTS		
	2P	4P		H	L	LA	LB		HH	HB	HD	HL	HE	HA	L4	N° BOLTS	Weight (Kg)	F1	F2	□ N	P	ød1 x l	m
90 S	1.5	1.1	24	90				2	232	940	580	180	360	400	80	4	--	1100	550	120	250	M14 x 270	40
90 L	2.2	1.5																					
100 L	3.0	2.2 3.0	28	100																			
112 M	4.0	4.0	28	112																			
132 S	5.5 7.5	5.5	38	132																			
132 M	9.2	7.5	38	132																			

Motor:

Pump model: CN MAG-M 25-160/1 1/2x1x6

DATE:

ITEM:

PURCHASE ORDER:

CUSTOMER NAME:

OUTLINE DRAWING

CODE: D14374 Rev.:00

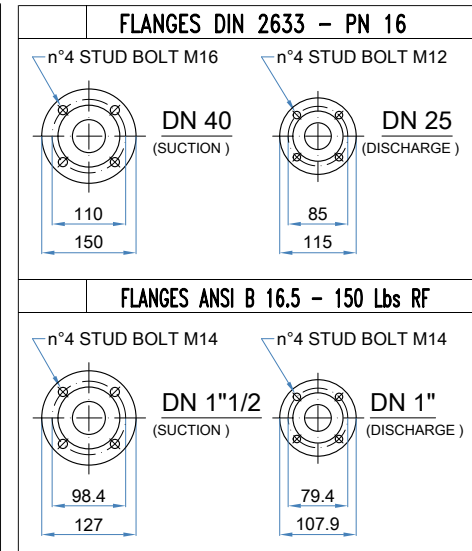
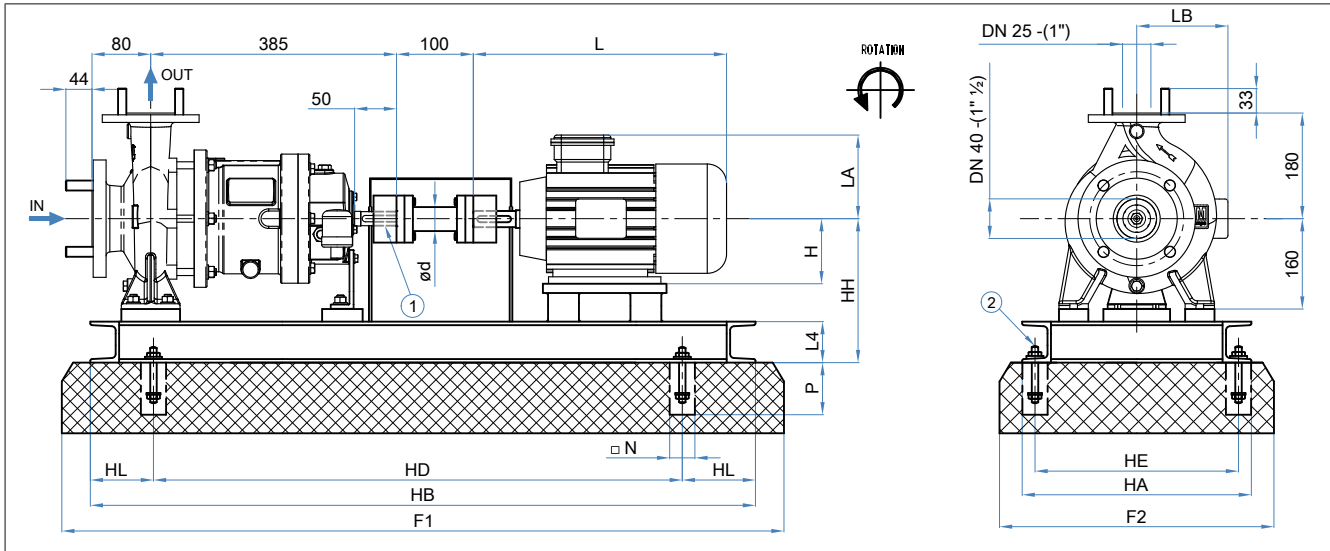

PART. 1		PART. 2		FOOT PRINT SKETCH	PUMP LUBRICATION		WEIGHT (kg)	
DIN	ANSI					STANDARD	Pump : 68	Joint : 5
				OPTIONAL		OIL EXXON TERESSO quantity 50 cc - Interval 3000 hours	JOINT	RU-STEEL AD 31-100

MOTOR	MAX. (Kw)		SHAFT ø d	DIMENSIONS				BASE PLATE N°	BASEPLATE (mm)								FOUNDATION (mm)				BOLTS		
	2P	4P		H	L	LA	LB		HH	HB	HD	HL	HE	HA	L4	N° BOLTS	Weight (Kg)	F1	F2	□ N	P	ød1 x l	m
90 S	1.5	1.1	24	90				2	260	940	580	180	360	400	80	4	--	1100	550	120	250	M14 x 270	40
90 L	2.2	1.5																					
100 L	3.0	2.2 3.0	28	100																			
112 M	4.0	4.0	28	112																			
132 S	5.5 7.5	5.5	38	132																			
132 M	9.2	7.5	38	132																			

Motor:

Pump model: CN MAG-M 25-200 / 1 1/2 x 1 x 8

DATE:

ITEM:

PURCHASE ORDER:

CUSTOMER NAME:

OUTLINE DRAWING

CODE: D10158 Rev.:00

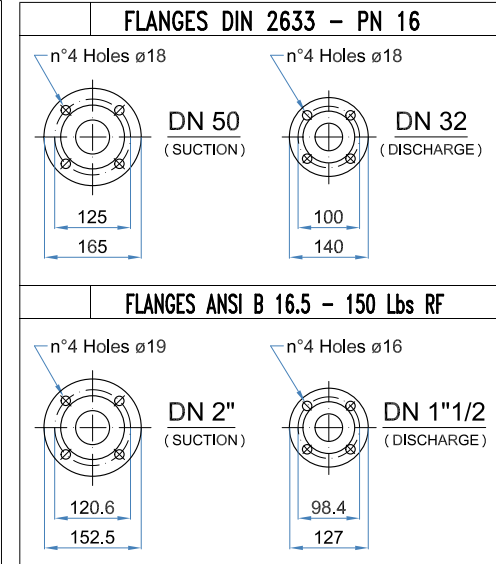
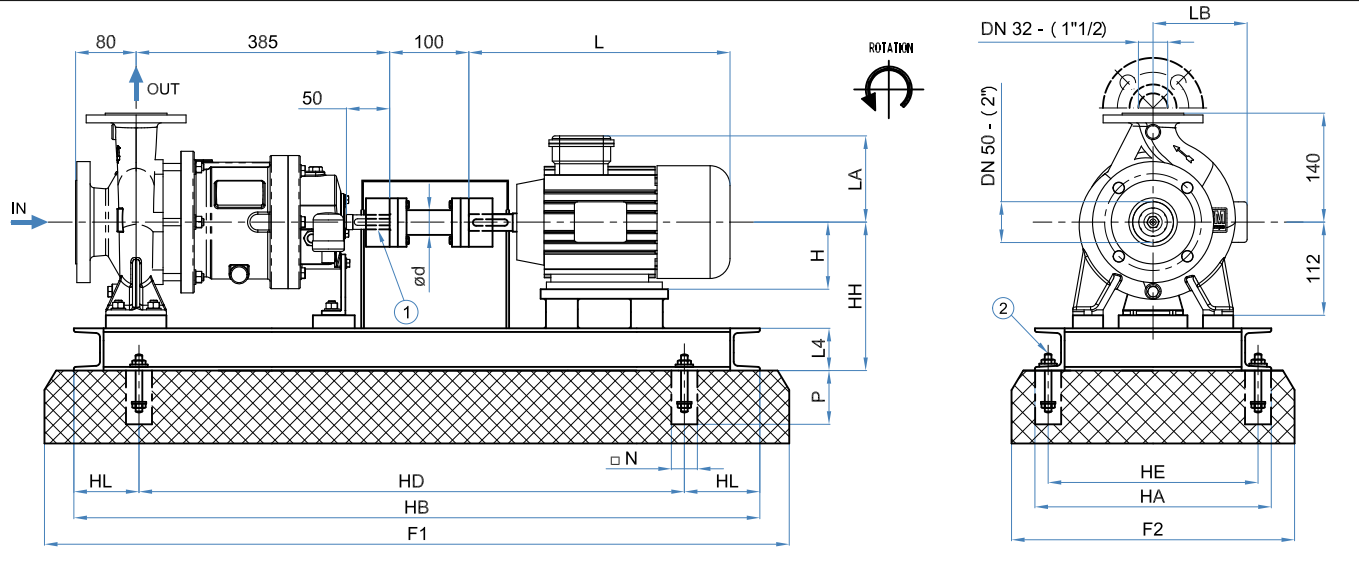

PART. 1		PART. 2		FOOT PRINT SKETCH		PUMP LUBRICATION		WEIGHT (kg)	
DIN	ANSI					STANDARD		Pump : 49	
		ϵ	ϵ	ϵ	ϵ	Ball Bearing Greased For Life Interval 20000 hours		Joint : 5	
		ϵ	ϵ	ϵ	ϵ	OPTIONAL			
		ϵ	ϵ	ϵ	ϵ	OIL EXXON TERESSO quantity 50 cc - Interval 3000 hours		JOINT	
		ϵ	ϵ	ϵ	ϵ			RU-STEEL AD 31-100	

Motor:

Pump model: CN MAG-M 32-125/2x1 1/2x5

MOTOR	MAX. (Kw)		SHAFT ø d	DIMENSIONS				BASE PLATE N°	BASEPLATE (mm)								FOUNDATION (mm)				BOLTS		
	2P	4P		H	L	LA	LB		HH	HB	HD	HL	HE	HA	L4	N° BOLTS	Weight (Kg)	F1	F2	□ N	P	ød1 x l	m
90 S	1.5	1.1	24	90				2	212	940	580	180	360	400	80	4	--	1100	550	120	250	M14 x 270	40
90 L	2.2	1.5																					
100 L	3.0	2.2	28	100				2	212	940	580	180	360	400	80	4	--	1100	550	120	250	M14 x 270	40
		3.0																					
112 M	4.0	4.0	28	112				2	232	940	580	180	360	400	80	4	--	1100	550	120	250	M14 x 270	40
132 S	5.5	5.5	38	132																			
	7.5																						
132 M	9.2	7.5	38	132				3	260	1100	700	200	400	80	4	--	1250	550	120	250	M16 x 270	60	
160 M	11.0	/	42	160																			
	15.0	/																					

DATE:

ITEM:

PURCHASE ORDER:

CUSTOMER NAME:

OUTLINE DRAWING

CODE: D10165 Rev.:00

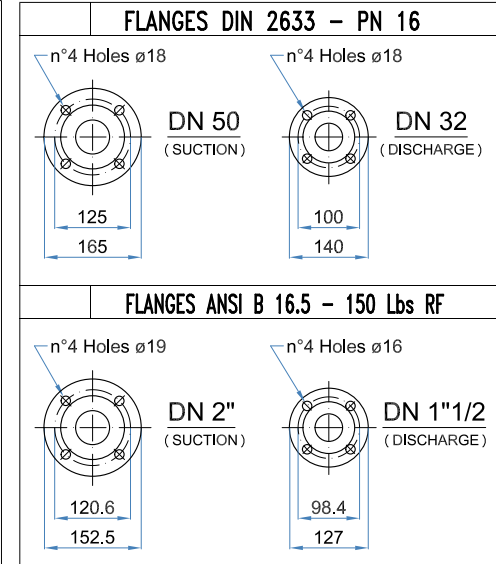
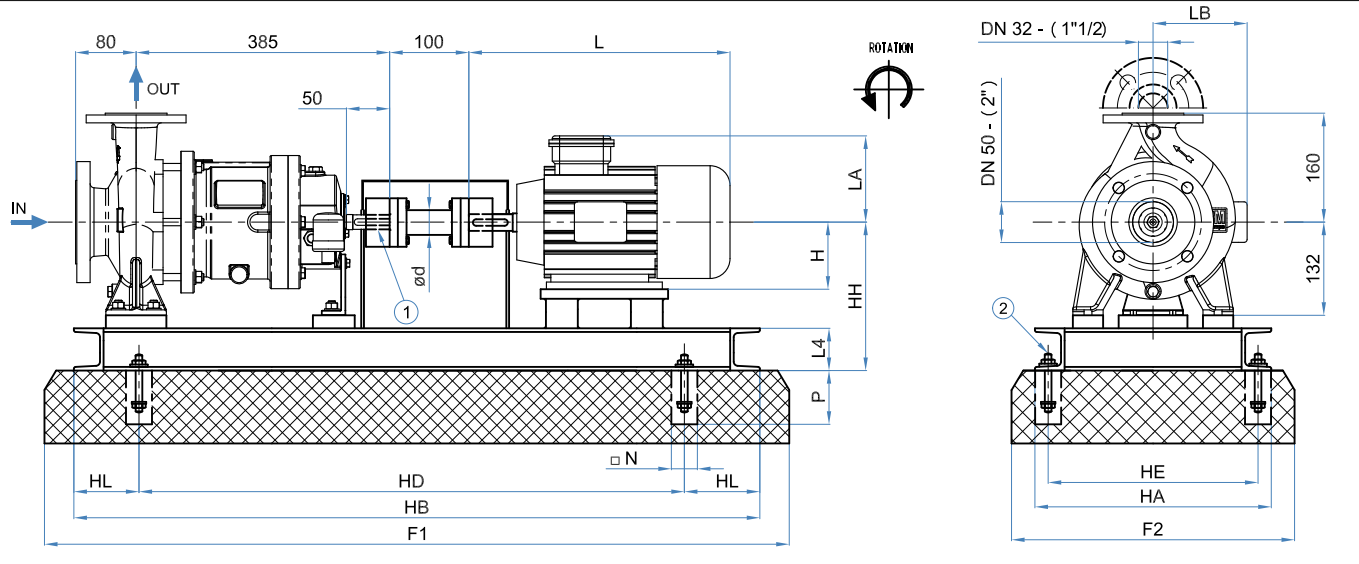

PART. 1		PART. 2		FOOT PRINT SKETCH	PUMP LUBRICATION		WEIGHT (kg)	
DIN	ANSI					STANDARD	Pump : 45	JOINT
				Ball Bearing Greased For Life Interval 20000 hours		Joint : 5		
					OPTIONAL			
					OIL EXXON TERESSO quantity 50 cc - Interval 3000 hours		RU-STEEL AD 31-100	

Motor:

Pump model: CN MAG-M 32-160/2x1 1/2x6

MOTOR	MAX. (Kw)		SHAFT $\varnothing d$	DIMENSIONS				BASE PLATE N°	BASEPLATE (mm)								FOUNDATION (mm)				BOLTS		
	2P	4P		H	L	LA	LB		HH	HB	HD	HL	HE	HA	L4	N° BOLTS	Weight (Kg)	F1	F2	$\square N$	P	$\varnothing d1 \times l$	m
90 S	1.5	1.1	24	90				2	232	940	580	180	360	400	80	4	--	1100	550	120	250	M14 x 270	40
90 L	2.2	1.5																					
100 L	3.0	2.2	28	100				2	232	940	580	180	360	400	80	4	--	1100	550	120	250	M14 x 270	40
		3.0																					
112 M	4.0	4.0	28	112				2	232	940	580	180	360	400	80	4	--	1100	550	120	250	M14 x 270	40
132 S	5.5	5.5	38	132				2	232	940	580	180	360	400	80	4	--	1100	550	120	250	M14 x 270	40
	7.5																						
132 M	9.2	7.5	38	132				2	232	940	580	180	360	400	80	4	--	1100	550	120	250	M14 x 270	40
160 M	11.0	/	42	160				3	280	1100	700	200			100	4	--	1250				M16 x 270	60
	15.0	/																					

DATE:

ITEM:

PURCHASE ORDER:

CUSTOMER NAME:

OUTLINE DRAWING

CODE: D10168 Rev.:00

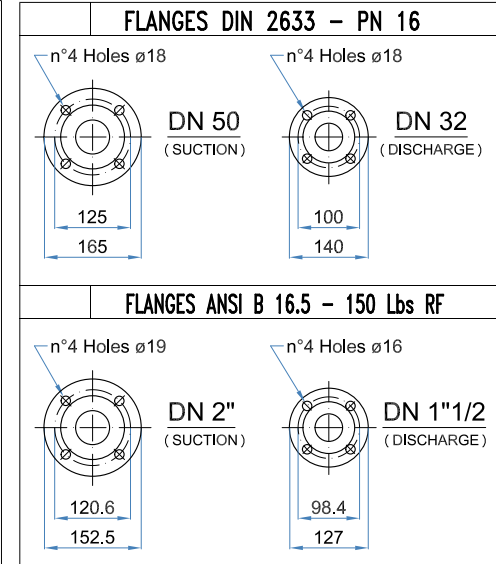
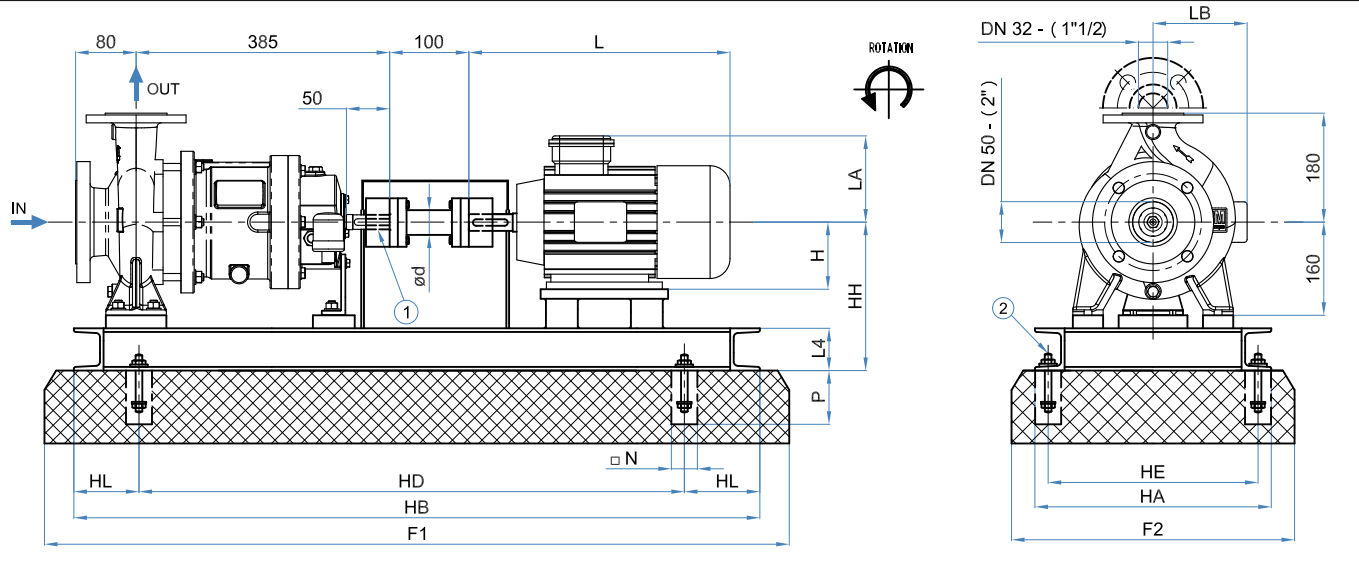

PART. 1		PART. 2		FOOT PRINT SKETCH	PUMP LUBRICATION		WEIGHT (kg)	
DIN	ANSI					STANDARD	Pump : 68	Joint : 5
					Ball Bearing Greased For Life Interval 20000 hours			
					OPTIONAL		JOINT	
					OIL EXXON TERESSO quantity 50 cc - Interval 3000 hours		RU-STEEL AD 31-100	

Motor:

Pump model: CN MAG-M 32-200/2x1 1/2x8

MOTOR	MAX. (Kw)		SHAFT ø d	DIMENSIONS				BASE PLATE N°	BASEPLATE (mm)								FOUNDATION (mm)				BOLTS		
	2P	4P		H	L	LA	LB		HH	HB	HD	HL	HE	HA	L4	N° BOLTS	Weight (Kg)	F1	F2	□ N	P	ød1 x l	m
90 S	1.5	1.1	24	90				2	260	940	580	180	360	400	80	4	--	1100	550	120	250	M14 x 270	40
90 L	2.2	1.5																					
100 L	3.0	2.2	28	100				2	260	940	580	180	360	400	80	4	--	1100	550	120	250	M14 x 270	40
		3.0																					
112 M	4.0	4.0	28	112				2	260	940	580	180	360	400	80	4	--	1100	550	120	250	M14 x 270	40
132 S	5.5	5.5	38	132				2	260	940	580	180	360	400	80	4	--	1100	550	120	250	M14 x 270	40
	7.5																						
132 M	9.2	7.5	38	132				2	260	940	580	180	360	400	80	4	--	1100	550	120	250	M14 x 270	40
160 M	11.0	/	42	160				3	280	1100	700	200			100	4	--	1250				M16 x 270	60
	15.0	/																					

DATE:

ITEM:

PURCHASE ORDER:

CUSTOMER NAME:

OUTLINE DRAWING

CODE: D10166 Rev.:00

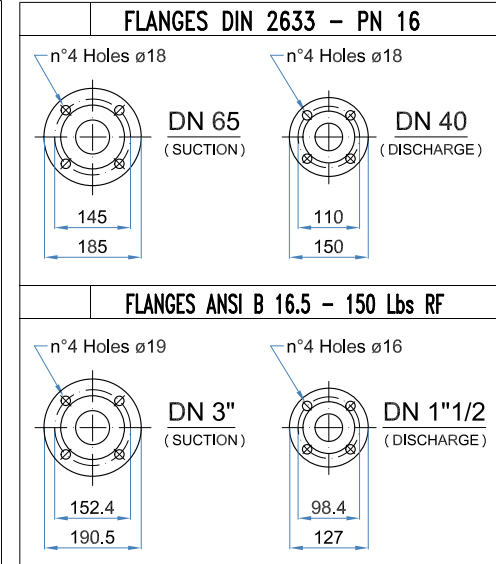
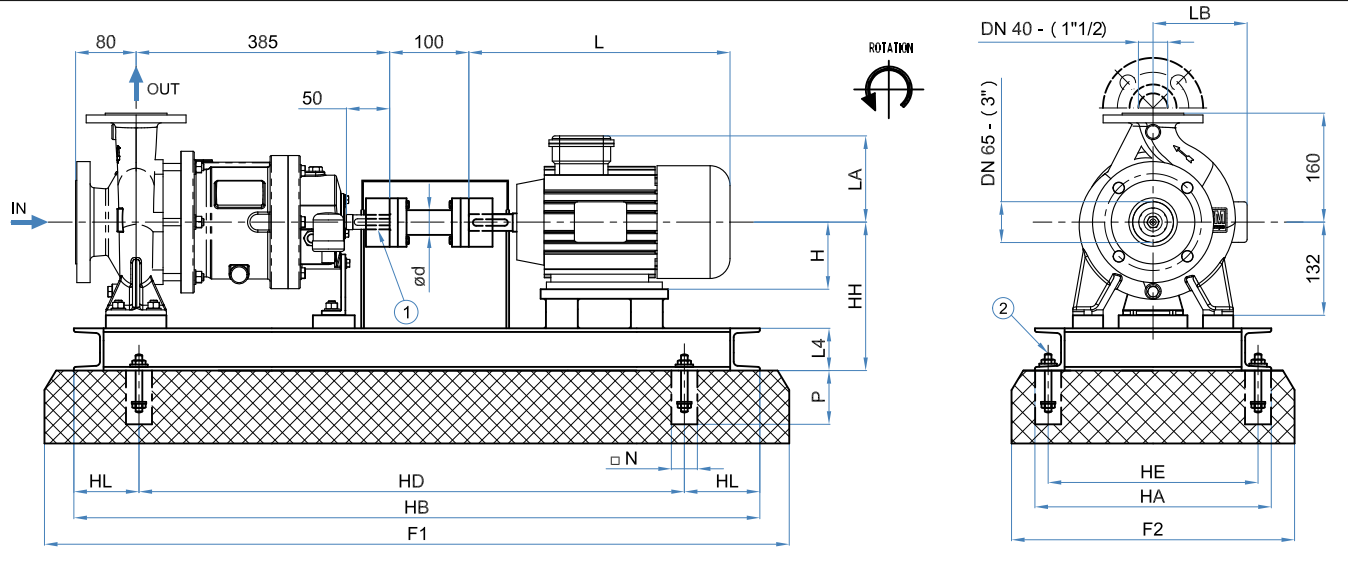

PART. 1		PART. 2		FOOT PRINT SKETCH	PUMP LUBRICATION		WEIGHT (kg)	
DIN	ANSI					STANDARD	Pump : 60	Joint : 5
					Ball Bearing Greased For Life Interval 20000 hours			
					OPTIONAL		JOINT	
					OIL EXXON TERESSO quantity 50 cc - Interval 3000 hours		RU-STEEL AD 31-100	

Motor:

Pump model: CN MAG-M 40-160/3x1 1/2x6

MOTOR	MAX. (Kw)		SHAFT ø d	DIMENSIONS				BASE PLATE N°	BASEPLATE (mm)								FOUNDATION (mm)				BOLTS			
	2P	4P		H	L	LA	LB		HH	HB	HD	HL	HE	HA	L4	N° BOLTS	Weight (Kg)	F1	F2	□ N	P	ød1 x l	m	
90 S	1.5	1.1	24	90																				
90 L	2.2	1.5																						
100 L	3.0	2.2	28	100				2	232	940	580	180	360	400	80	4	--	1100	550	120	250	M14 x 270	40	
		3.0																						
112 M	4.0	4.0	28	112																				
132 S	5.5	5.5	38	132																				
	7.5																							
132 M	9.2	7.5	38	132																				
160 M	11.0	/	42	160				3	280	1100	700	200												
	15.0	/																						

DATE:

ITEM:

PURCHASE ORDER:

CUSTOMER NAME:

OUTLINE DRAWING

CODE: D10172 Rev.:00

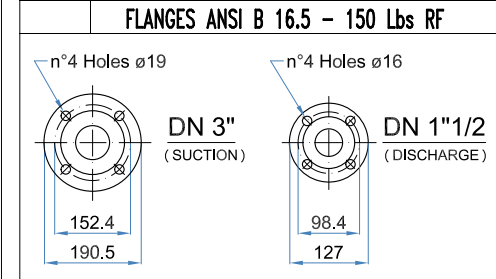
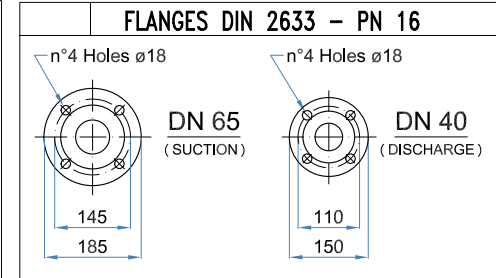
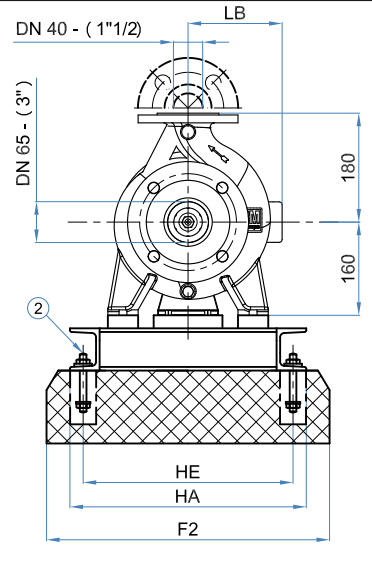
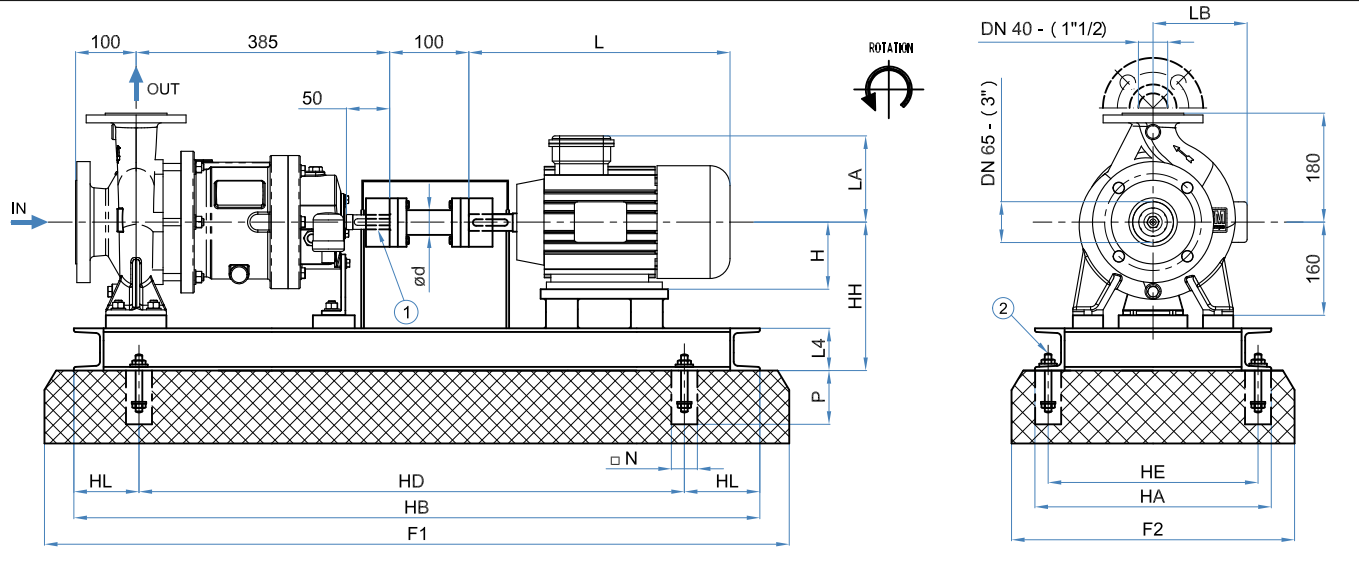

PART. 1		PART. 2		FOOT PRINT SKETCH		PUMP LUBRICATION		WEIGHT (kg)	
DIN	ANSI					STANDARD	Ball Bearing Greased For Life Interval 20000 hours	Pump : ---	Joint : ---
						OPTIONAL	OIL EXXON TERESSO quantity 220 cc - Interval 3000 hours		

Motor:

Pump model: CN MAG-M 40-200 3x1 1/2x8

DATE: _____

ITEM: _____

PURCHASE ORDER: _____

CUSTOMER NAME: _____

MOTOR	MAX. (Kw)		SHAFT ø d	DIMENSIONS				BASE PLATE N°	BASEPLATE (mm)								FOUNDATION (mm)				BOLTS		
	2P	4P		H	L	LA	LB		HH	HB	HD	HL	HE	HA	L4	N° BOLTS	Weight (Kg)	F1	F2	□ N	P	ød1 x l	m
80 A	0.75	0.55	19	80				3	260	900	600	150	350	390	80	4	--	1050	540	120	250	M16 x 270	40
80 B	1.1	0.75																					
90 S	1.5	1.1	24	90				3	260	900	600	150	350	390	80	4	--	1050	540	120	250	M16 x 270	40
90 L	2.2	1.5																					
100 L	3.0	2.2	28	100				3	260	900	600	150	350	390	80	4	--	1050	540	120	250	M16 x 270	40
		3.0																					
112 M	4.0	4.0	28	112				3	260	900	600	150	350	390	80	4	--	1050	540	120	250	M16 x 270	40
132 S	5.5	5.5	38	132				4	260	1000	660	170	400	450	80	4	--	1150	600	120	250	M20 x 270	40
	7.5																						
132 M	9.2	7.5	38	132				4	260	1000	660	170	400	450	80	4	--	1150	600	120	250	M20 x 270	40
160 M	11.0	/	42	160				5	260	1120	740	190	440	490	80	4	--	1270	640	120	250	M20 x 270	40
	15.0	/																					

OUTLINE DRAWING

CODE: D10161 Rev.:00

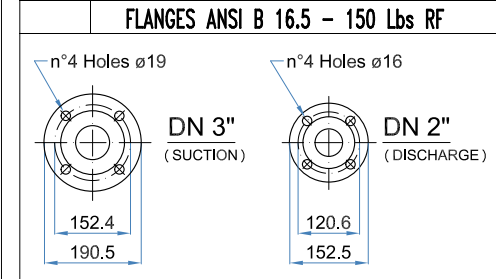
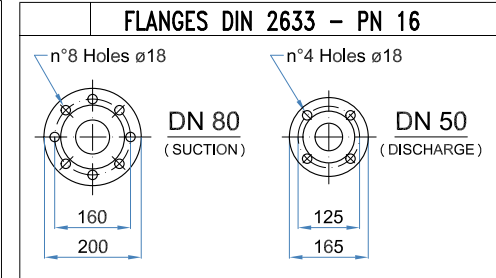
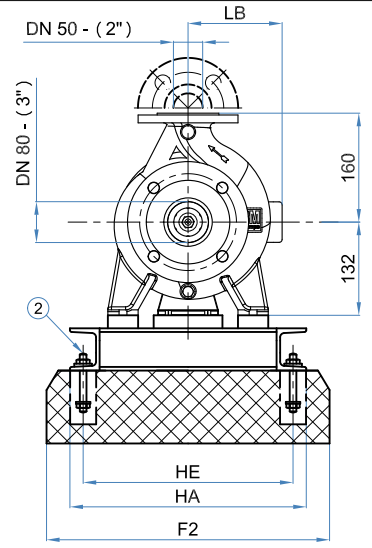
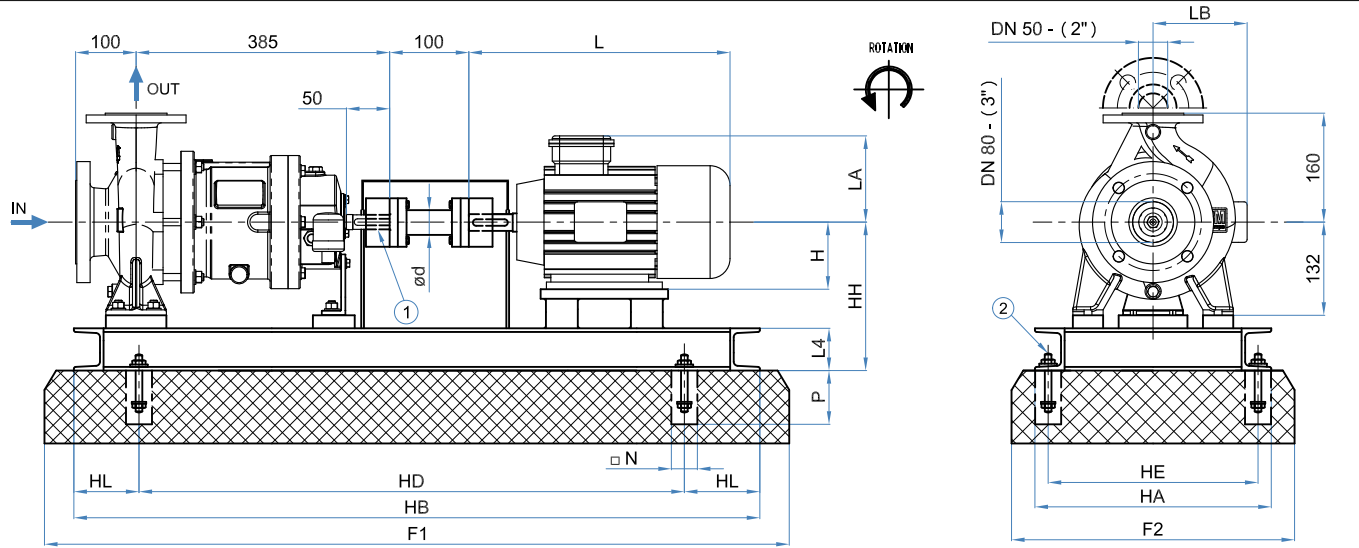

PART. 1		PART. 2		FOOT PRINT SKETCH		PUMP LUBRICATION		WEIGHT (kg)	
DIN	ANSI					STANDARD		Pump : 61	
						Ball Bearing Greased For Life Interval 20000 hours		Joint : 5	
						OPTIONAL			
						OIL EXXON TERESSO quantity 50 cc - Interval 3000 hours		JOINT	
								RU-STEEL AD 31-100	

Motor:

Pump model: CN MAG-M 50-125/3x2x5

MOTOR	MAX. (Kw)		SHAFT ø d	DIMENSIONS				BASE PLATE N°	BASEPLATE (mm)								FOUNDATION (mm)				BOLTS			
	2P	4P		H	L	LA	LB		HH	HB	HD	HL	HE	HA	L4	N° BOLTS	Weight (Kg)	F1	F2	□ N	P	ød1 x l	m	
90 S	1.5	1.1	24	90				2	232	940	580	180	360	400	80	4	--	1100	550	120	250	M14 x 270	40	
90 L	2.2	1.5																						
100 L	3.0	2.2	28	100				2	232	940	580	180	360	400	80	4	--	1100	550	120	250	M14 x 270	40	
		3.0																						
112 M	4.0	4.0	28	112				2	232	940	580	180	360	400	80	4	--	1100	550	120	250	M14 x 270	40	
132 S	5.5	5.5	38	132				2	232	940	580	180	360	400	80	4	--	1100	550	120	250	M14 x 270	40	
	7.5																							
132 M	9.2	7.5	38	132				2	232	940	580	180	360	400	80	4	--	1100	550	120	250	M14 x 270	40	
160 M	11.0	/	42	160				3	280	1100	700	200			100	4	--	1250					M16 x 270	60
	15.0	/																						

DATE: _____

ITEM: _____

PURCHASE ORDER: _____

CUSTOMER NAME: _____

OUTLINE DRAWING

CODE: D10167 Rev.:00

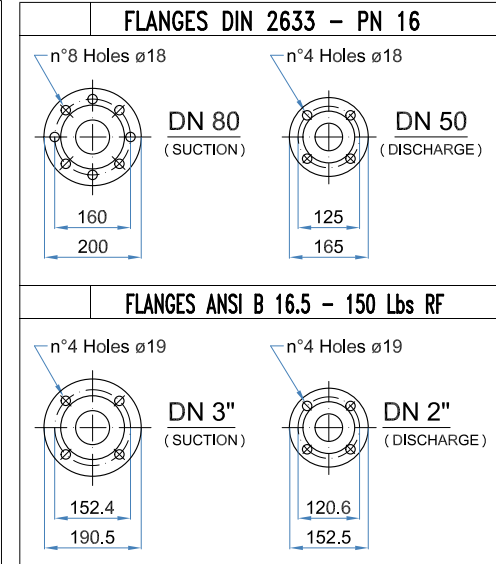
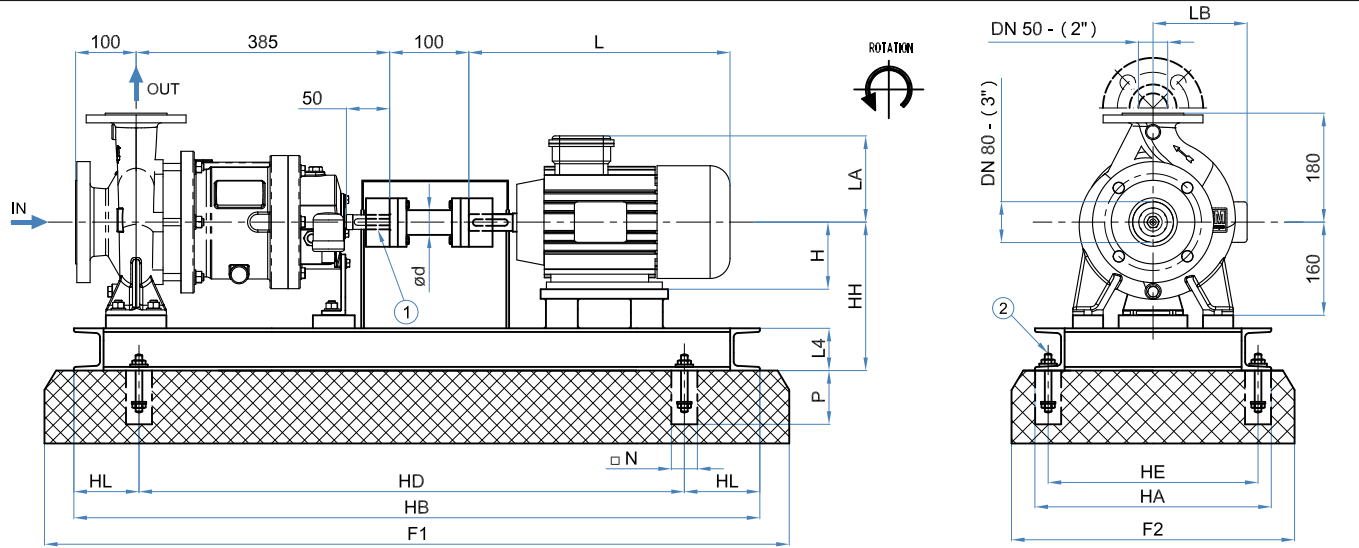

PART. 1		PART. 2		FOOT PRINT SKETCH		PUMP LUBRICATION		WEIGHT (kg)	
DIN	ANSI		Top of scarf field foundation ANCHOR BOLT		STANDARD	Pump : 65			
					Ball Bearing Greased For Life Interval 20000 hours	Joint : 5			
					OPTIONAL	JOINT			
					OIL EXXON TERESSO quantity 50 cc - Interval 3000 hours	RU-STEEL AD 31-100			

MOTOR	MAX. (Kw)		SHAFT ø d	DIMENSIONS				BASE PLATE N°	BASEPLATE (mm)								FOUNDATION (mm)				BOLTS			
	2P	4P		H	L	LA	LB		HH	HB	HD	HL	HE	HA	L4	N° BOLTS	Weight (Kg)	F1	F2	□ N	P	ød1 x l	m	
90 S	1.5	1.1	24	90																				
90 L	2.2	1.5																						
100 L	3.0	2.2	28	100				2	260	940	580	180	360	400	80	4	--	1100	550	120	250	M14 x 270	40	
		3.0																						
112 M	4.0	4.0	28	112																				
132 S	5.5	5.5	38	132																				
	7.5																							
132 M	9.2	7.5	38	132																				
160 M	11.0	/	42	160																				
	15.0	/																						
180 M	22	22	48	180				3	280	1100	700	200												

Motor:

Pump model: CN MAG-M 50-160/3x2x6

DATE:

ITEM:

PURCHASE ORDER:

CUSTOMER NAME:

OUTLINE DRAWING

CODE: D10173 Rev.:00

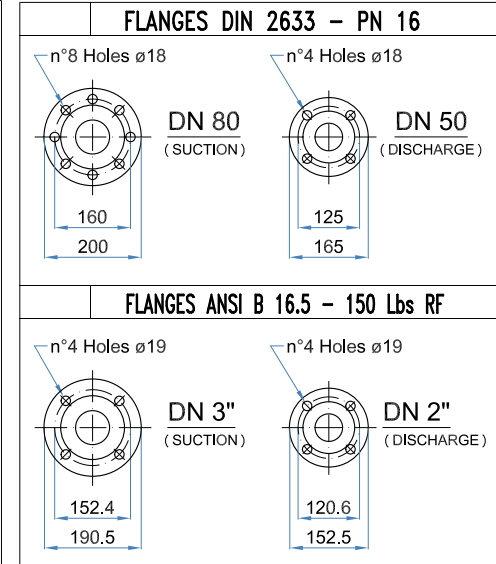
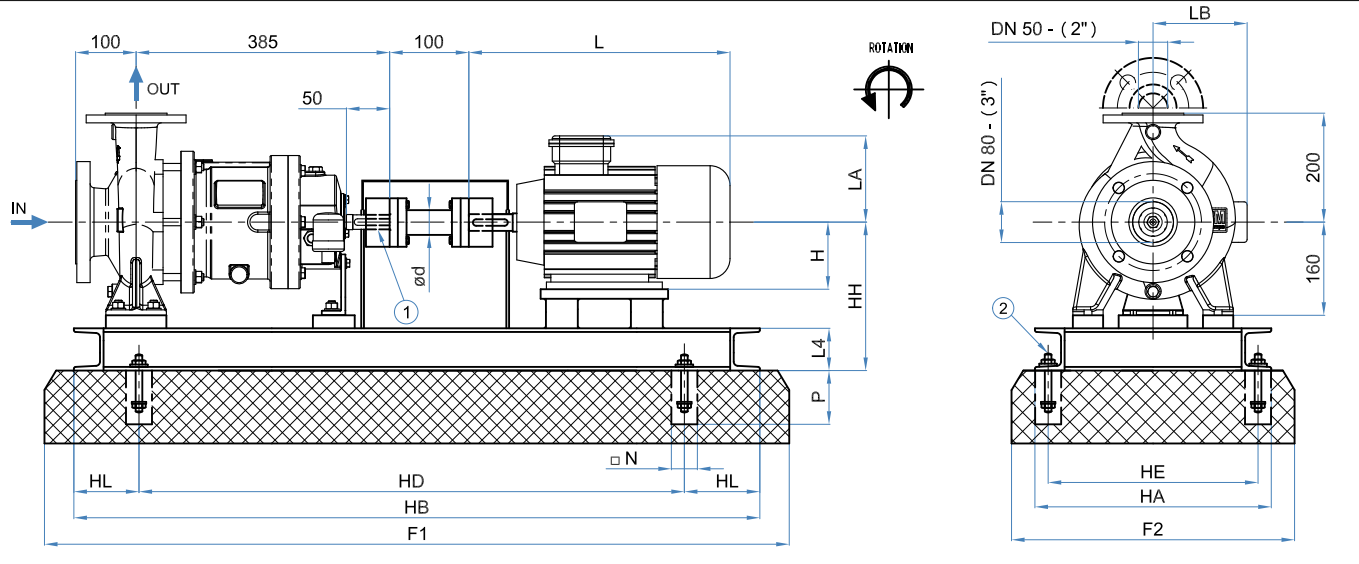

PART. 1		PART. 2		FOOT PRINT SKETCH	PUMP LUBRICATION		WEIGHT (kg)	
DIN	ANSI					STANDARD	Pump : 81	
					Ball Bearing Greased For Life Interval 20000 hours	Joint : 5		
					OPTIONAL		JOINT	
					OIL EXXON TERESSO quantity 50 cc - Interval 3000 hours		RU-STEEL AD 31-100	

MOTOR	MAX. (Kw)		SHAFT ø d	DIMENSIONS				BASE PLATE N°	BASEPLATE (mm)								FOUNDATION (mm)				BOLTS				
	2P	4P		H	L	LA	LB		HH	HB	HD	HL	HE	HA	L4	N° BOLTS	Weight (Kg)	F1	F2	□ N	P	ød1 x l	m		
90 S	1.5	1.1	24	90																					
90 L	2.2	1.5																							
100 L	3.0	2.2	28	100				2	260	940	580	180	360	400	80	4	--	1100	550	120	250	M14 x 270	40		
		3.0																							
112 M	4.0	4.0	28	112																					
132 S	5.5	5.5	38	132																					
	7.5																								
132 M	9.2	7.5	38	132																					
160 M	11.0	/	42	160				3	280	1100	700	200													
	15.0	/																							

Motor:

Pump model: CN MAG-M 50-200/3x2x8

DATE:

ITEM:

PURCHASE ORDER:

CUSTOMER NAME:

OUTLINE DRAWING

CODE: D10164 Rev.:00

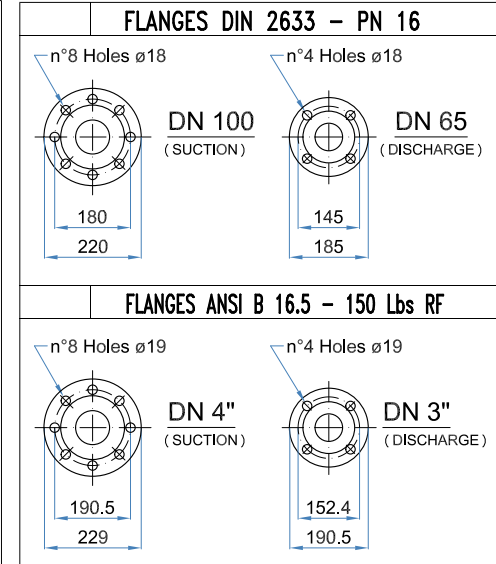
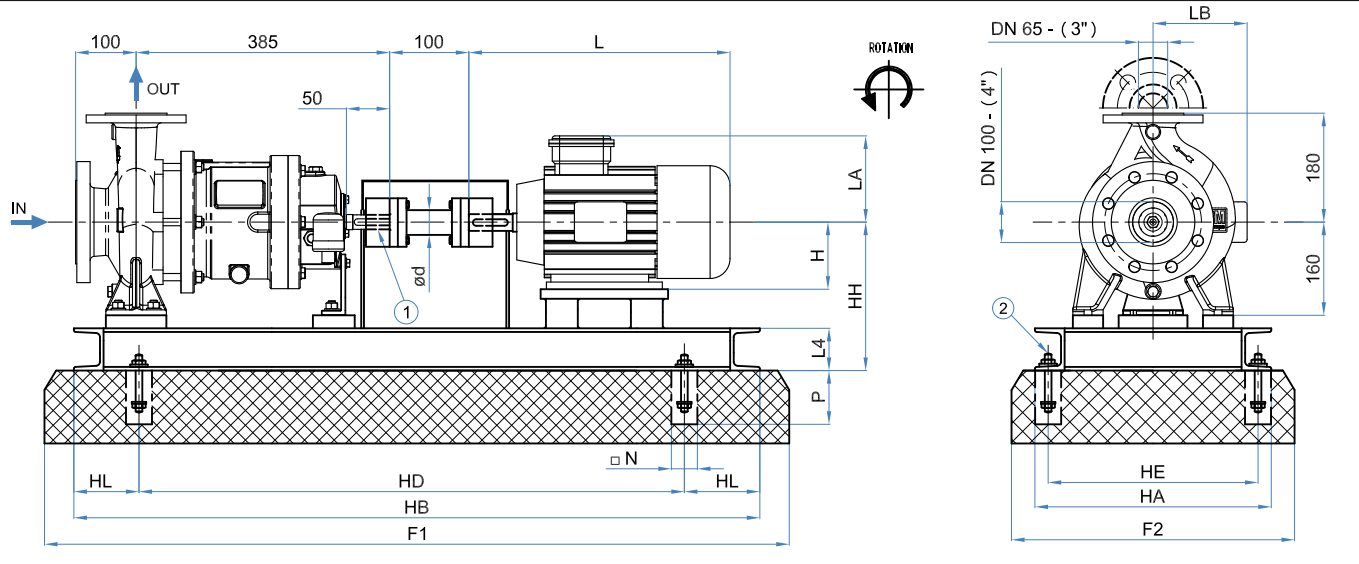

PART. 1		PART. 2		FOOT PRINT SKETCH		PUMP LUBRICATION		WEIGHT (kg)	
DIN	ANSI		Top of scarf field foundation ANCHOR BOLT		n°4holes ø14 n°2holes ø14	STANDARD	Ball Bearing Greased For Life Interval 20000 hours	Pump : 73	Joint : 5
						OPTIONAL	OIL EXXON TERESSO quantity 50 cc - Interval 3000 hours	JOINT RU-STEEL AD 31-100	

Motor:

Pump model: CN MAG-M 65-125/4x3x5

DATE:

ITEM:

PURCHASE ORDER:

CUSTOMER NAME:

MOTOR	MAX. (Kw)		SHAFT ø d	DIMENSIONS				BASE PLATE N°	BASEPLATE (mm)								FOUNDATION (mm)				BOLTS		
	2P	4P		H	L	LA	LB		HH	HB	HD	HL	HE	HA	L4	N° BOLTS	Weight (Kg)	F1	F2	□ N	P	ød1 x l	m
90 S	1.5	1.1	24	90				2	260	940	580	180	360	400	80	4	--	1100	550	120	250	M14 x 270	40
90 L	2.2	1.5																					
100 L	3.0	2.2	28	100				2	260	940	580	180	360	400	80	4	--	1100	550	120	250	M14 x 270	40
		3.0																					
112 M	4.0	4.0	28	112				2	260	940	580	180	360	400	80	4	--	1100	550	120	250	M14 x 270	40
132 S	5.5	5.5	38	132				2	260	940	580	180	360	400	80	4	--	1100	550	120	250	M14 x 270	40
	7.5																						
132 M	9.2	7.5	38	132				2	260	940	580	180	360	400	80	4	--	1100	550	120	250	M14 x 270	40
160 M	11.0	/	42	160				3	280	1100	700	200			100	4	--	1250				M16 x 270	60
	15.0	/																					

OUTLINE DRAWING

CODE: D10178 Rev.:00

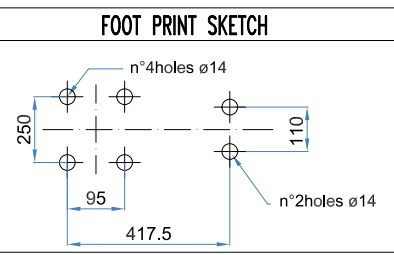
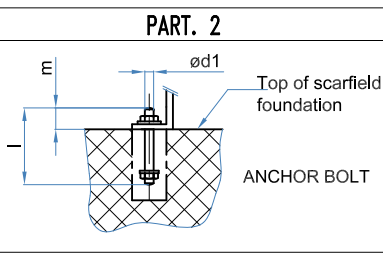
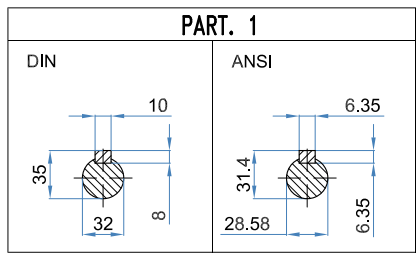
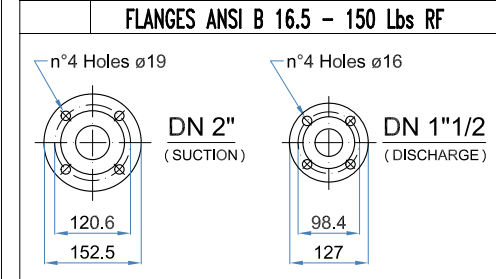
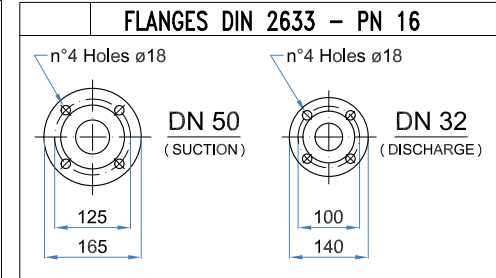
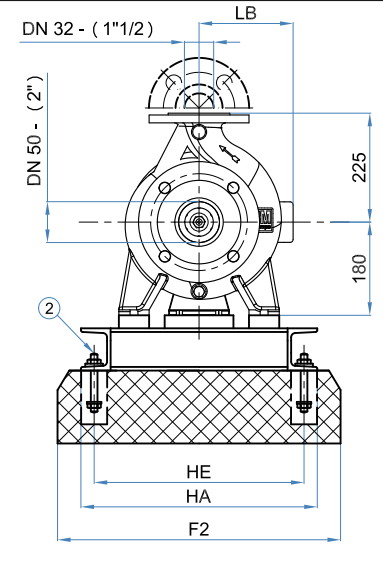
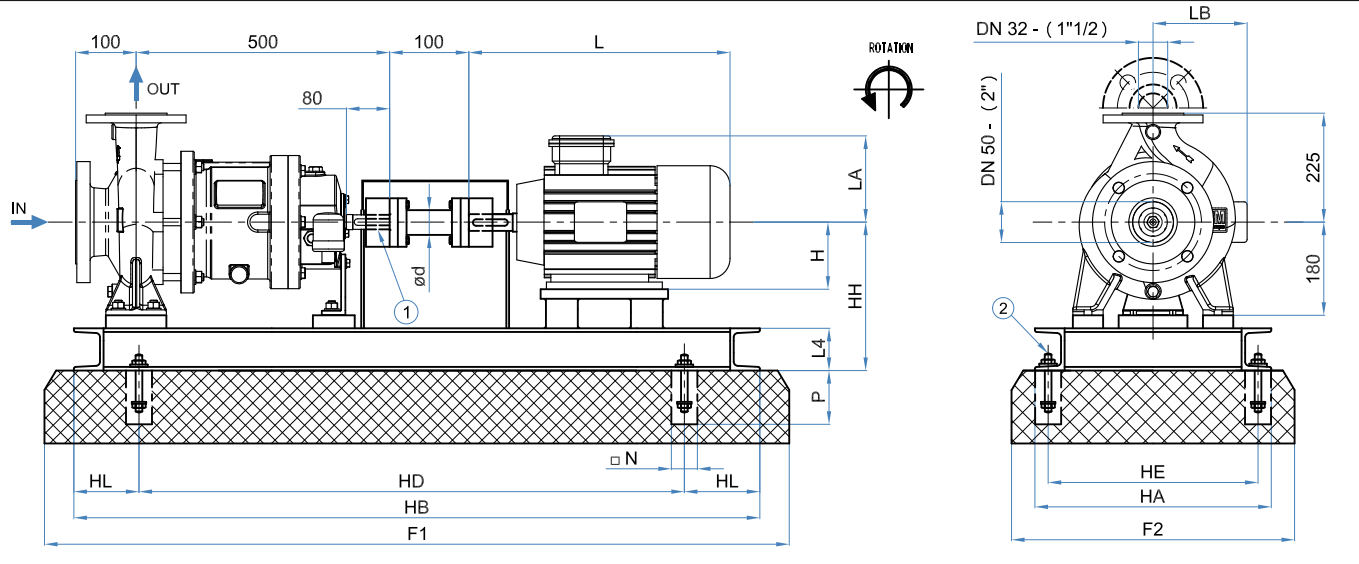

PUMP LUBRICATION

STANDARD
Ball Bearing Greased For Life Interval 20000 hours

OPTIONAL
OIL EXXON TERESSO quantity 350 cc - Interval 3000 hours

WEIGHT (kg)

Pump : 125
Joint : 10 / 15

JOINT RU-STEEL

P ≤37 Kw AD 41-100
P >37 Kw AD 51-100

MOTOR	MAX. (Kw)		SHAFT ø d	DIMENSIONS				BASE PLATE N°	BASEPLATE (mm)								FOUNDATION (mm)				BOLTS				
	2P	4P		H	L	LA	LB		HH	HB	HD	HL	HE	HA	L4	N° BOLTS	Weight (Kg)	F1	F2	□ N	P	ød1 x l	m		
132 S	5.5	5.5	38	132				3		1100	700			360	400		--	1250	550				M16 x 270	60	
	7.5																								
132 M	9.2	7.5	38	132																					
160 M	11.0	11.0	42	160				300																	
	15.0	-																							
160 L	18.5	15.0	48																						
180 M	22.0	18.5	48	180																					
180 L	-	22.0	48					4		1400	1000	200	460	500	100	4	--	1550	650	120	250	M18 x 270			
200 L	30.0	30.0	55	200				320																	
	37.0																								
225 S	-	37.0	60	225				345																	
225 M	45.0	45.0	55																						
250 M	55.0	-	60	250				5	375	1550	1050	250	510	550				1700	700						

Motor:

Pump model: CN MAG-M 32-250/2x1 1/2x10

DATE:

ITEM:

PURCHASE ORDER:

CUSTOMER NAME:

OUTLINE DRAWING

CODE: D10179 Rev.:00

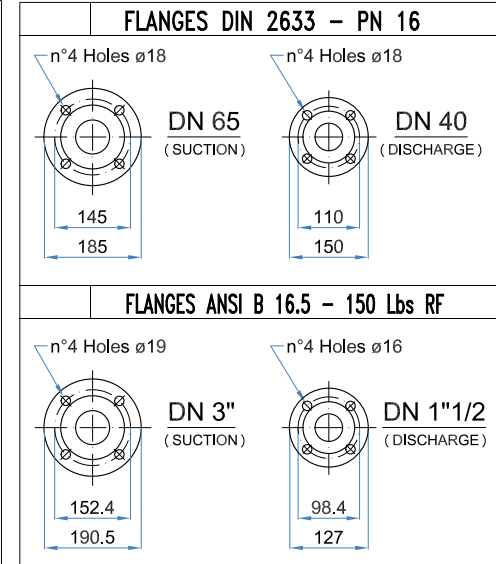
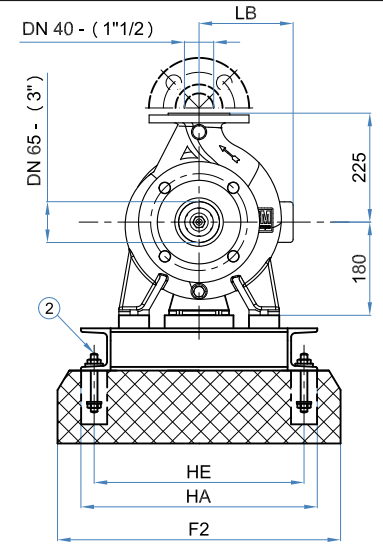
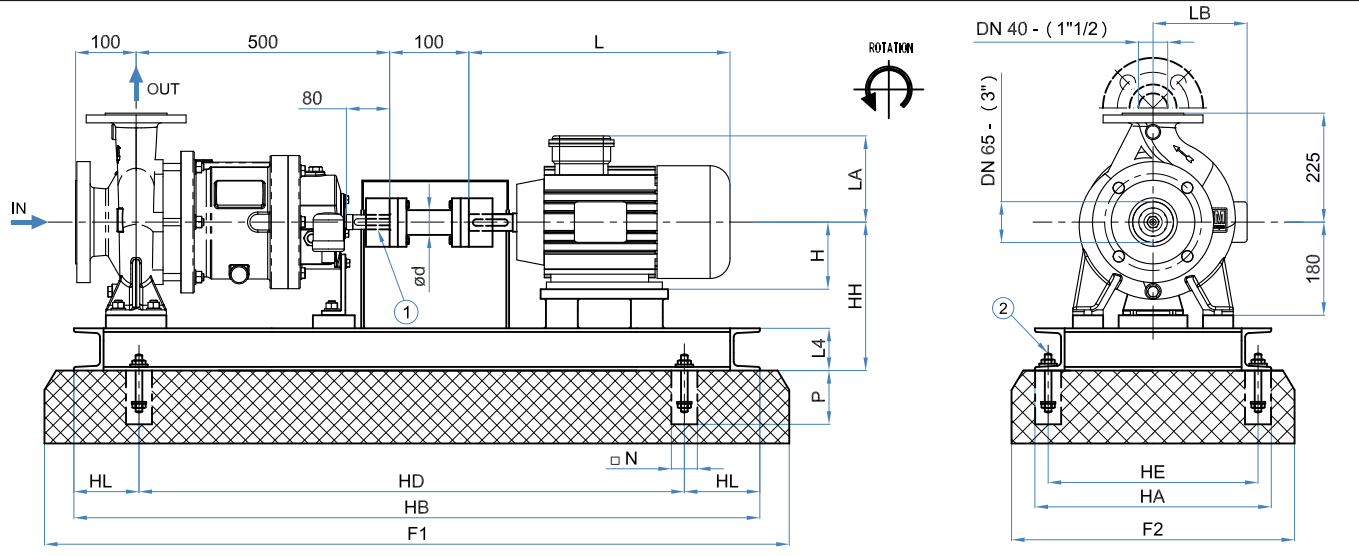

PART. 1		PART. 2		FOOT PRINT SKETCH		PUMP LUBRICATION		WEIGHT (kg)	
DIN	ANSI					STANDARD Ball Bearing Greased For Life Interval 20000 hours		Pump : 128 Joint : 10 / 15	
		ANCHOR BOLT				OPTIONAL OIL EXXON TERESSO quantity 350 cc - Interval 3000 hours		JOINT RU-STEEL P ≤37 Kw AD 41-100 P >37 Kw AD 51-100	

MOTOR	MAX. (Kw)		SHAFT ø d	DIMENSIONS				BASE PLATE N°	BASEPLATE (mm)								FOUNDATION (mm)				BOLTS				
	2P	4P		H	L	LA	LB		HH	HB	HD	HL	HE	HA	L4	N° BOLTS	Weight (Kg)	F1	F2	□ N	P	ød1 x l	m		
132 S	5.5	5.5	38	132				3		1100	700			360	400			--	1250	550			M16 x 270		
	7.5																								
132 M	9.2	7.5	38	132																					
160 M	11.0	11.0	42	160				300																	
	15.0	-																							
160 L	18.5	15.0	48	160																					
180 M	22.0	18.5	48	180																					
180 L	-	22.0	48	180				4		1400	1000	200	460	500	100	4	--	1550	650	120	250	M18 x 270			
200 L	30.0	30.0	55	200				320																	
	37.0																								
225 S	-	37.0	60	225				345																	
225 M	45.0	45.0	55	225																					
250 M	55.0	-	60	250				5	375	1550	1050	250	510	550				1700	700						

Motor:
 Pump model: CN MAG-M 40-250/5x1 1/2x10

DATE:
 ITEM:
 PURCHASE ORDER:
 CUSTOMER NAME:

OUTLINE DRAWING

CODE: D10183 Rev.:00

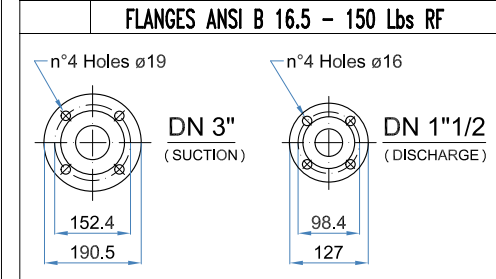
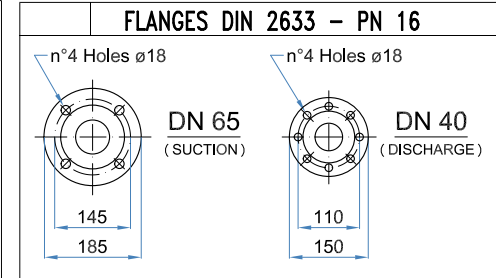
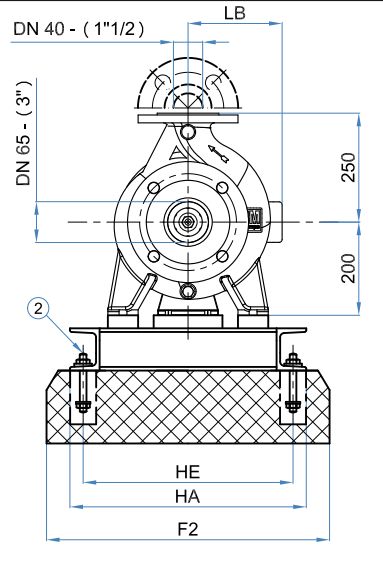
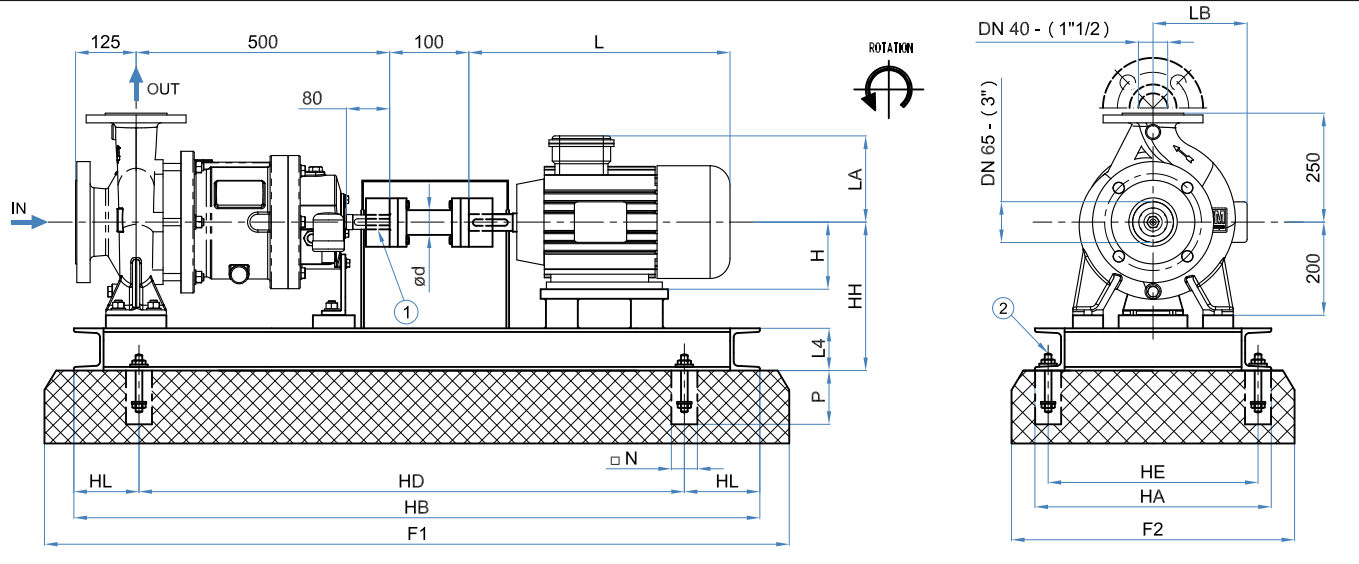

PART. 1		PART. 2		FOOT PRINT SKETCH	PUMP LUBRICATION		WEIGHT (kg)	
DIN	ANSI		ANCHOR BOLT			STANDARD	Pump : 155	
				Ball Bearing Greased For Life Interval 20000 hours		Joint : 10 / 15		
					OPTIONAL	JOINT RU-STEEL		
					OIL EXXON TERESSO quantity 350 cc - Interval 3000 hours	P ≤37 Kw	AD 41-100	
						P >37 Kw	AD 51-100	

Motor:

Pump model: CN MAG-M 40-315/3x1 1/2x13

DATE: _____

ITEM: _____

PURCHASE ORDER: _____

CUSTOMER NAME: _____

MOTOR	MAX. (Kw)		SHAFT ø d	DIMENSIONS				BASE PLATE N°	BASEPLATE (mm)								FOUNDATION (mm)				BOLTS				
	2P	4P		H	L	LA	LB		HH	HB	HD	HL	HE	HA	L4	N° BOLTS	Weight (Kg)	F1	F2	□ N	P	ød1 x l	m		
132 S	5.5	5.5	38	132				3	1100	700				360	400		--	1250	550					M16 x 270	60
	7.5																								
132 M	9.2	7.5	38	132				320	1400	1000	200	460	500	100	4	--	1550	650	120	250	M18 x 270	60			
160 M	11.0	11.0	42	160																					
160 L	18.5	15.0	48	160				4	1400	1000	200	460	500	100	4	--	1550	650	120	250	M18 x 270	60			
180 M	22.0	18.5	48	180																					
180 L	-	22.0	48	180				4	1400	1000	200	460	500	100	4	--	1550	650	120	250	M18 x 270	60			
200 L	30.0		55	200																					
200 L	37.0	30.0	55	200				4	1400	1000	200	460	500	100	4	--	1550	650	120	250	M18 x 270	60			
225 S	-	37.0	60	225																					
225 M	45.0	45.0	55	225				5	1550	1050	250	510	550												
250 M	55.0	-	60	250																					

OUTLINE DRAWING

CODE: D10180 Rev.:00

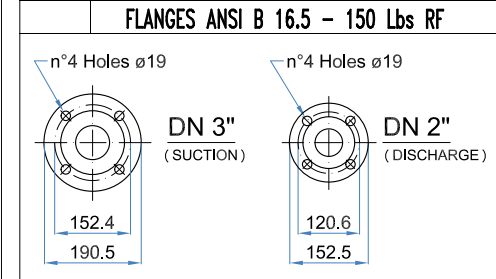
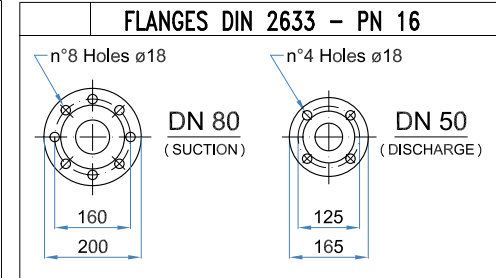
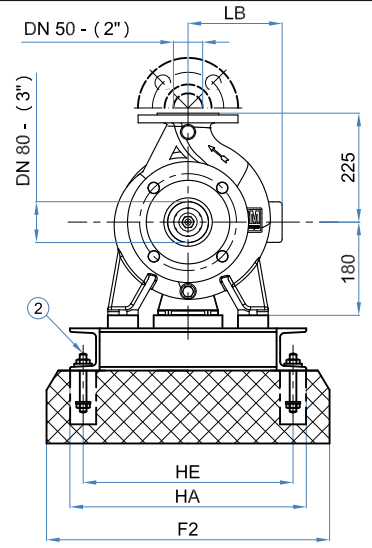
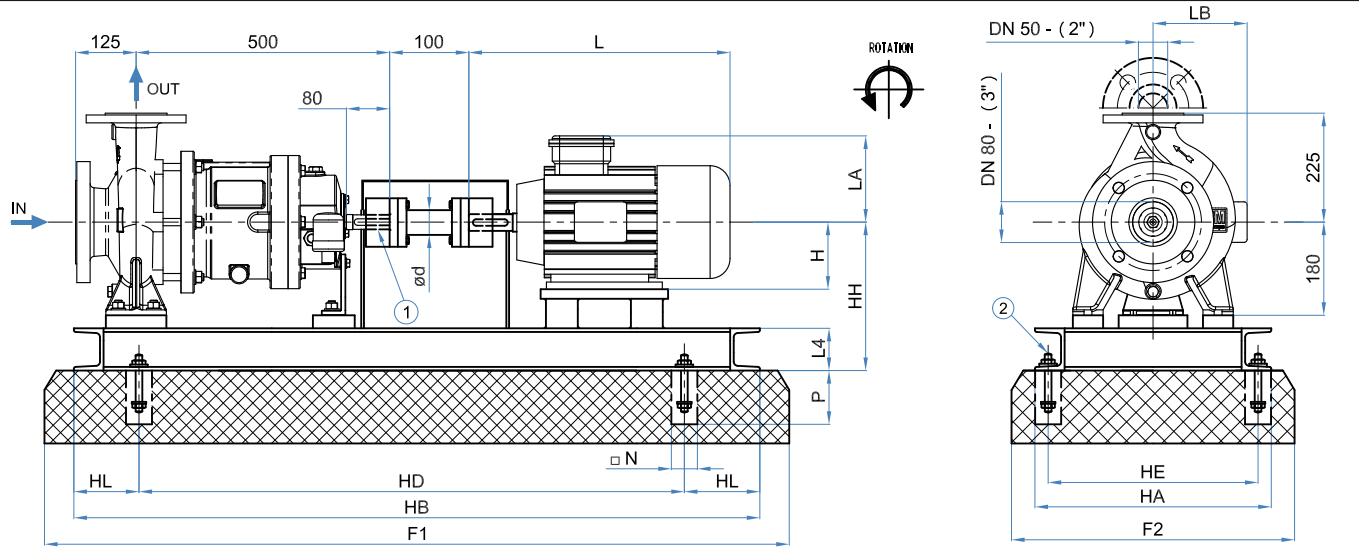

PART. 1		PART. 2		FOOT PRINT SKETCH		PUMP LUBRICATION		WEIGHT (kg)	
DIN	ANSI					STANDARD		Pump : 131	
						Ball Bearing Greased For Life Interval 20000 hours		Joint : 10 / 15	
						OPTIONAL		JOINT RU-STEEL	
						OIL EXXON TERESSO quantity 350 cc - Interval 3000 hours		P ≤37 Kw	AD 41-100
								P >37 Kw	AD 51-100

MOTOR	MAX. (Kw)		SHAFT ø d	DIMENSIONS				BASE PLATE N°	BASEPLATE (mm)								FOUNDATION (mm)				BOLTS				
	2P	4P		H	L	LA	LB		HH	HB	HD	HL	HE	HA	L4	N° BOLTS	Weight (Kg)	F1	F2	□ N	P	ød1 x l	m		
132 S	5.5		38	132				3		1100	700			360	400			--	1250	550			M16 x 270		
	7.5																								
132 M	9.2	7.5	38	132																					
160 M	11.0	11.0	42	160				300																	
	15.0	-																							
160 L	18.5	15.0	48																						
180 M	22.0	18.5	48	180																					
180 L	-	22.0	48					4		1400	1000	200	460	500	100	4	--	1550	650	120	250	M18 x 270			
200 L	30.0		55	200				320																	
	37.0	30.0																							
225 S	-	37.0	60	225				345																	
225 M	45.0	45.0	55																						
250 M	55.0	-	60	250				5	375	1550	1050	250	510	550				1700	700						

Motor:

Pump model: CN MAG-M 50-250/3x2x10

DATE:

ITEM:

PURCHASE ORDER:

CUSTOMER NAME:

OUTLINE DRAWING

CODE: D10184 Rev.:00

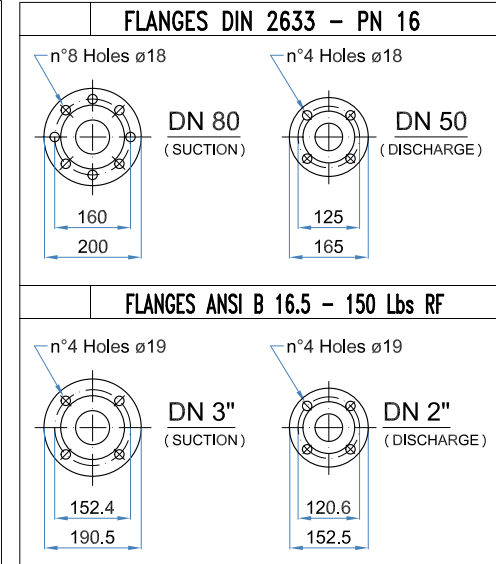
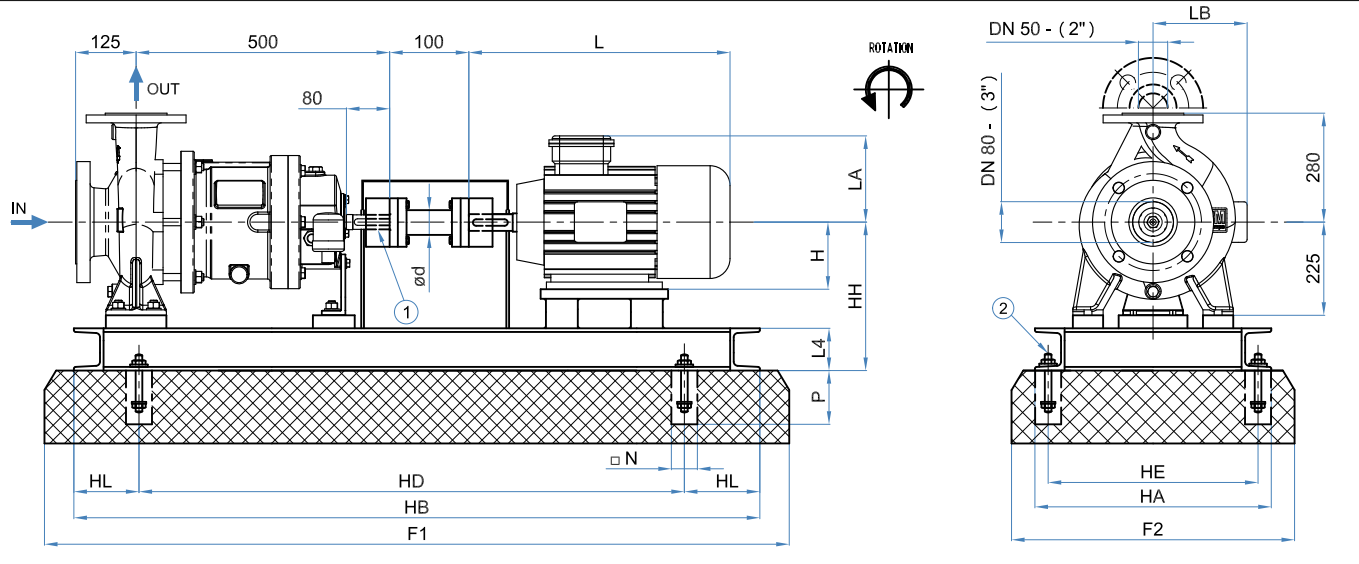

PART. 1		PART. 2		FOOT PRINT SKETCH	PUMP LUBRICATION		WEIGHT (kg)	
DIN	ANSI					STANDARD	Pump : 160	
				Ball Bearing Greased For Life Interval 20000 hours		Joint : 10 / 15		
					OPTIONAL	JOINT RU-STEEL		
					OIL EXXON TERESSO quantity 350 cc - Interval 3000 hours	P ≤37 Kw	AD 41-100	
						P >37 Kw	AD 51-100	

MOTOR	MAX. (Kw)		SHAFT ø d	DIMENSIONS				BASE PLATE N°	BASEPLATE (mm)								FOUNDATION (mm)				BOLTS			
	2P	4P		H	L	LA	LB		HH	HB	HD	HL	HE	HA	L4	N° BOLTS	Weight (Kg)	F1	F2	□ N	P	ød1 x l	m	
132 S	5.5	5.5	38	132				3	1100	700			360	400			--	1250	550			M16 x 270	60	
	7.5																							
132 M	9.2	7.5	38	132																				
160 M	11.0	11.0	42	160				4	1400	1000	200	460	500	100	4	--	1550	650	120	250	M18 x 270	60		
	15.0	-																						
160 L	18.5	15.0	48	160																				
180 M	22.0	18.5	48	180																				
180 L	-	22.0	48	180																				
200 L	30.0	30.0	55	200				4	1400	1000	200	460	500	100	4	--	1550	650	120	250	M18 x 270	60		
	37.0																							
225 S	-	37.0	60	225																				
225 M	45.0	45.0	55	225																				
250 M	55.0	-	60	250				5	375	1550	1050	250	510	550										

Motor:

Pump model: CN MAG-M 50-315/3x2x13

DATE:

ITEM:

PURCHASE ORDER:

CUSTOMER NAME:

OUTLINE DRAWING

CODE: D10174 Rev.:01

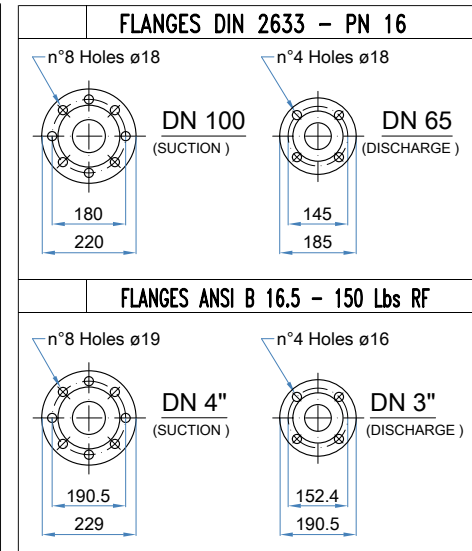
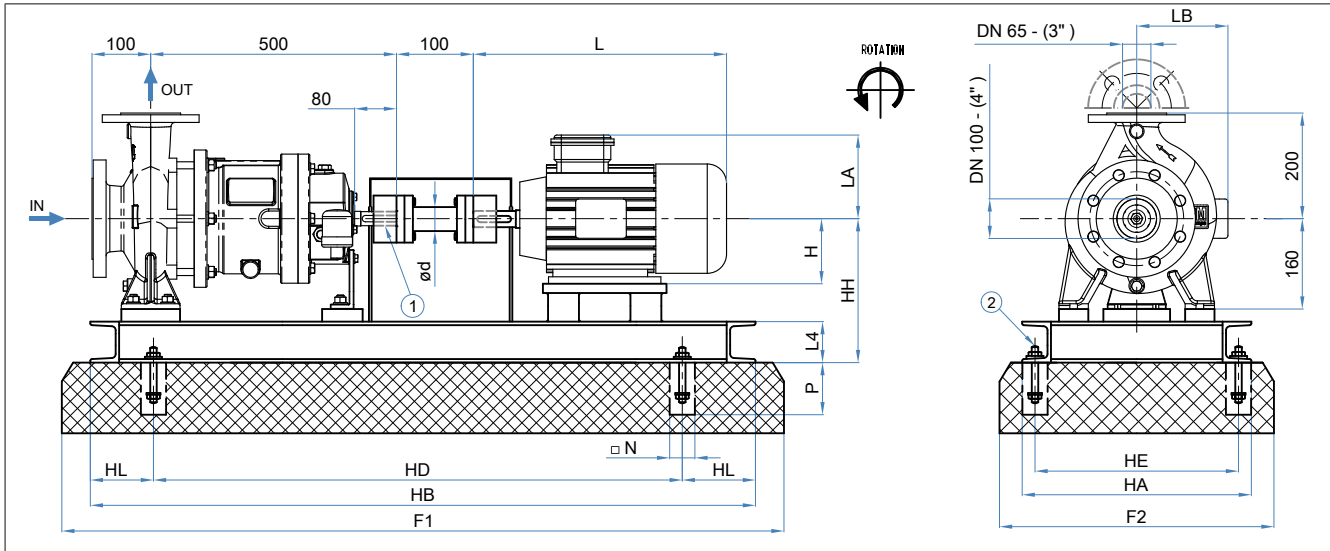

PART. 1		PART. 2		FOOT PRINT SKETCH	PUMP LUBRICATION		WEIGHT (kg)	
DIN	ANSI		Top of scarf field foundation ANCHOR BOLT			STANDARD	Pump : 85	JOINT RU-STEEL
				Ball Bearing Greased For Life Interval 20000 hours		Joint : 10 / 15		
					OPTIONAL	P ≤37 Kw AD 41-100		
					OIL EXXON TERESSO quantity 350 cc - Interval 3000 hours	P >37 Kw AD 51-100		

MOTOR	MAX. (Kw)		SHAFT	DIMENSIONS				BASE PLATE	BASEPLATE (mm)							FOUNDATION (mm)				BOLTS			
	2P	4P	Ø d	H	L	LA	LB	N°	HH	HB	HD	HL	HE	HA	L4	N° BOLTS	Weight (Kg)	F1	F2	□ N	P	Ød1 x l	m
132 S	5.5	5.5	38	132				3	280	1100	700		360	400			--	1250	550			M16 x 270	60
	7.5																						
132 M	9.2	7.5	38	132																			
160 M	11.0	11.0	42	160				4	300	1400	1000	200	460	500	100	4	--	1550	650	120	250	M18 x 270	60
	15.0	-																					
160 L	18.5	15.0	48	160																			
180 M	22.0	18.5	48	180																			
180 L	-	22.0	48	180																			
200 L	30.0	30.0	55	200				4	320														60
	37.0																						
225 S	-	37.0	60	225					345														
225 M	45.0	45.0	55	225																			
250 M	55.0	-	60	250				5	375	1550	1050	250	510	550				1700	700				

Motor:

Pump model: CN MAG-M 65-160/4x3/6

DATE:

ITEM:

PURCHASE ORDER:

CUSTOMER NAME:

OUTLINE DRAWING

CODE: D10176 Rev.:00

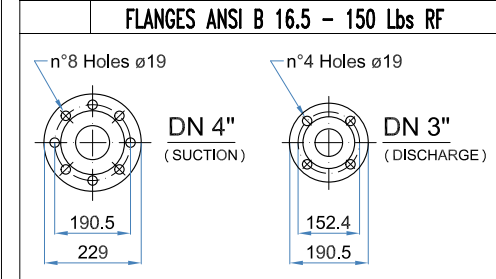
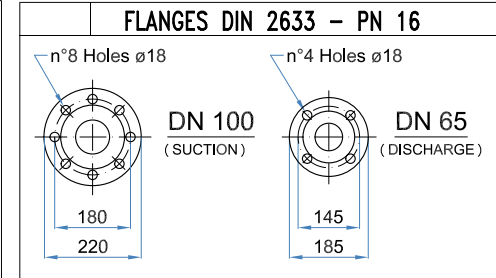
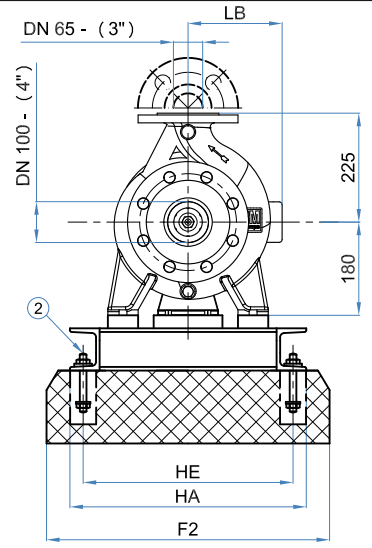
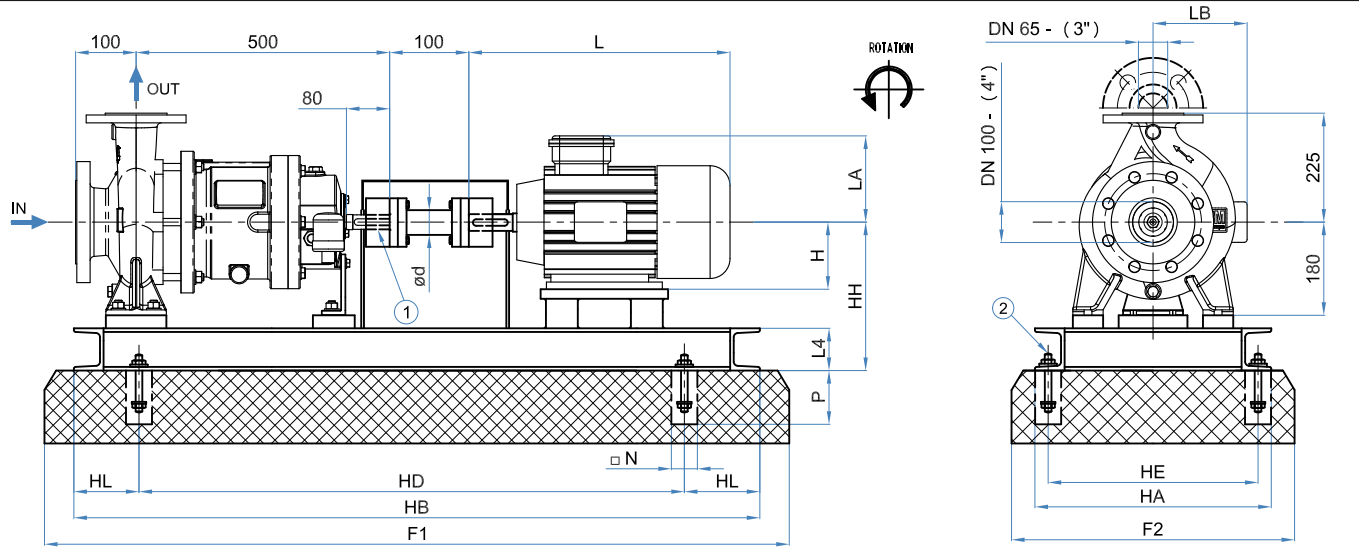

PART. 1		PART. 2		FOOT PRINT SKETCH	PUMP LUBRICATION		WEIGHT (kg)	
DIN	ANSI					STANDARD	Pump : 130	
				Ball Bearing Greased For Life Interval 20000 hours		Joint : 10 / 15		
					OPTIONAL	JOINT RU-STEEL		
					OIL EXXON TERESSO quantity 350 cc - Interval 3000 hours	P ≤37 Kw	AD 41-100	
						P >37 Kw	AD 51-100	

MOTOR	MAX. (Kw)		SHAFT Ø d	DIMENSIONS				BASE PLATE N°	BASEPLATE (mm)								FOUNDATION (mm)				BOLTS				
	2P	4P		H	L	LA	LB		HH	HB	HD	HL	HE	HA	L4	N° BOLTS	Weight (Kg)	F1	F2	□ N	P	Ød1 x l	m		
132 S	5.5	5.5	38	132				3		1100	700			360	400			--	1250	550			M16 x 270	60	
	7.5																								
132 M	9.2	7.5	38	132																					
160 M	11.0	11.0	42	160				300																	
	15.0	-																							
160 L	18.5	15.0	48																						
180 M	22.0	18.5	48	180																					
180 L	-	22.0	48					4		1400	1000	200	460	500	100	4	--	1550	650	120	250	M18 x 270			
200 L	30.0	30.0	55	200				320																	
	37.0																								
225 S	-	37.0	60	225				345																	
225 M	45.0	45.0	55																						
250 M	55.0	-	60	250				5	375	1550	1050	250	510	550				1700	700						

Motor:

Pump model: CN MAG-M 65-200/4x3x8

DATE:

ITEM:

PURCHASE ORDER:

CUSTOMER NAME:

OUTLINE DRAWING

CODE: D10181 Rev.:00

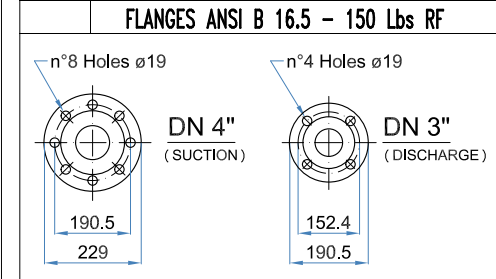
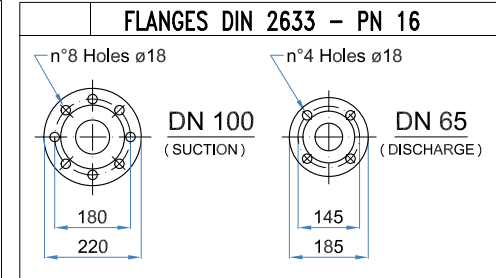
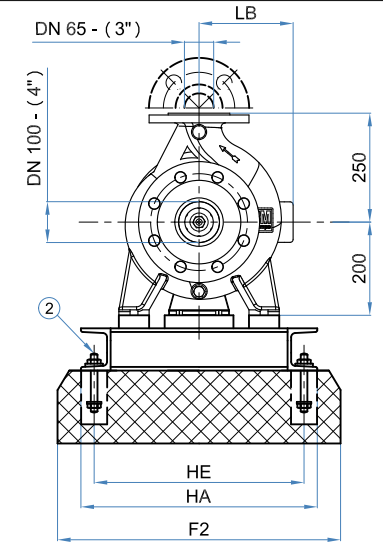
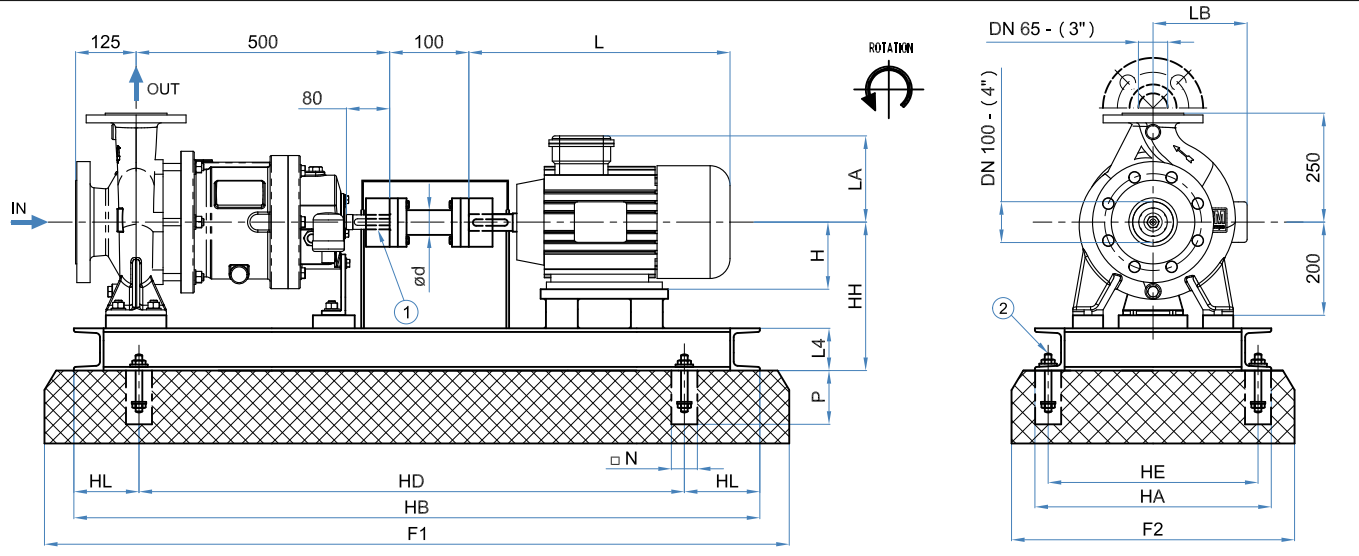

PART. 1		PART. 2		FOOT PRINT SKETCH		PUMP LUBRICATION		WEIGHT (kg)	
DIN	ANSI					STANDARD		Pump : 138	
						Ball Bearing Greased For Life Interval 20000 hours		Joint : 10 / 15	
						OPTIONAL		JOINT RU-STEEL	
						OIL EXXON TERESSO quantity 350 cc - Interval 3000 hours		P ≤37 Kw	AD 41-100
								P >37 Kw	AD 51-100

MOTOR	MAX. (Kw)		SHAFT ∅ d	DIMENSIONS				BASE PLATE N°	BASEPLATE (mm)								FOUNDATION (mm)				BOLTS				
	2P	4P		H	L	LA	LB		HH	HB	HD	HL	HE	HA	L4	N° BOLTS	Weight (Kg)	F1	F2	□ N	P	∅d1 x l	m		
132 S	5.5	5.5	38	132				3		1100	700			360	400			--	1250	550			M16 x 270		
	7.5																								
132 M	9.2	7.5	38	132																					
160 M	11.0	11.0	42	160				320																	
	15.0	-																							
160 L	18.5	15.0	48	180																					
180 M	22.0	18.5	48	180																					
180 L	-	22.0	48	180				4		1400	1000	200	460	500	100	4	--	1550	650	120	250	M18 x 270			
200 L	30.0	30.0	55	200				345																	
	37.0																								
225 S	-	37.0	60	225																					
225 M	45.0	45.0	55	225																					
250 M	55.0	-	60	250				5		375	1550	1050	250	510	550										

Motor:

Pump model: CN MAG-M 65-250/4x3x10

DATE:

ITEM:

PURCHASE ORDER:

CUSTOMER NAME:

OUTLINE DRAWING

CODE: D10175 Rev.:00

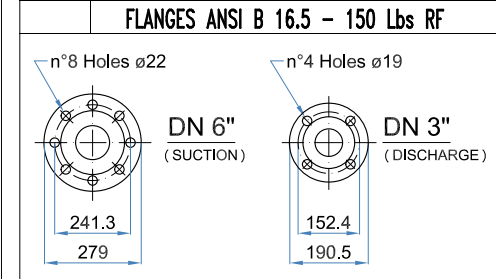
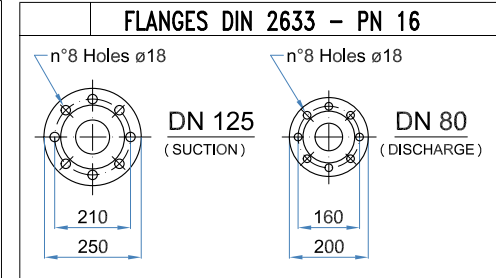
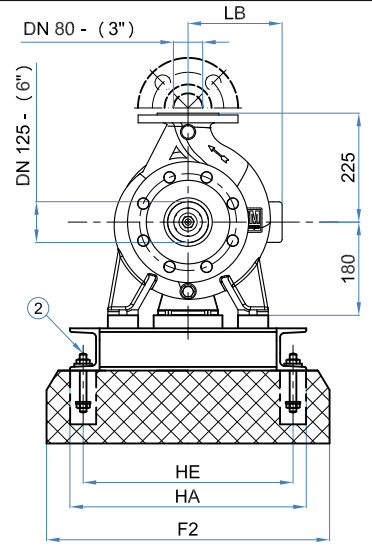
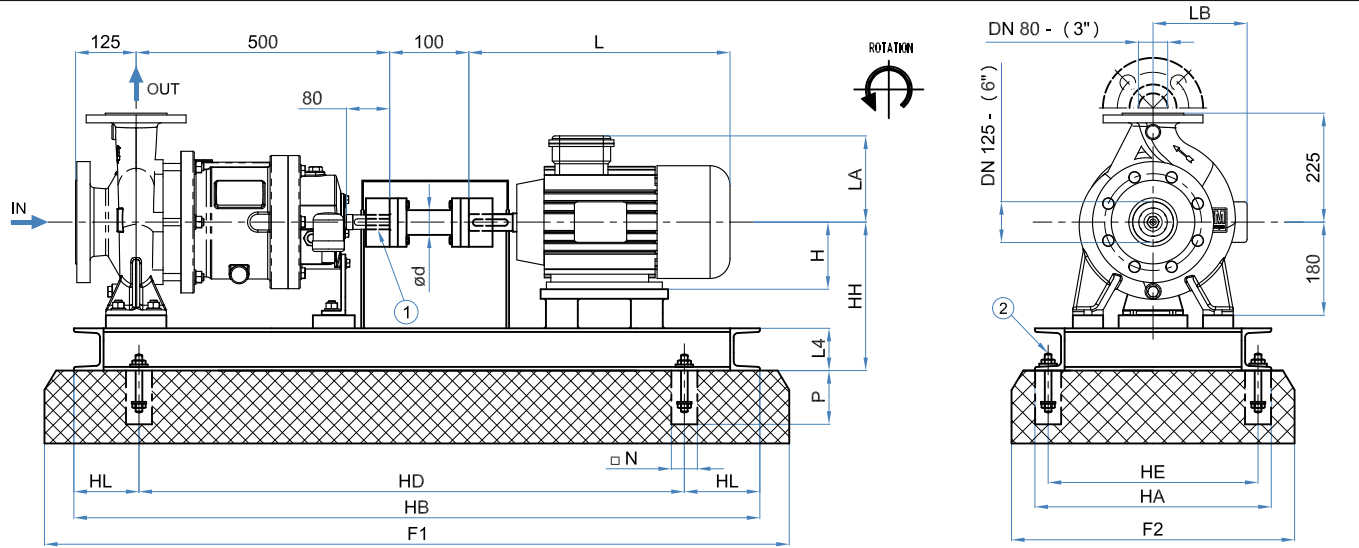

PART. 1		PART. 2		FOOT PRINT SKETCH	PUMP LUBRICATION		WEIGHT (kg)	
DIN	ANSI					STANDARD	Pump : 125	JOINT RU-STEEL
				Ball Bearing Greased For Life Interval 20000 hours		Joint : 10 / 15		
					OPTIONAL		P ≤ 37 Kw	AD 41-100
					OIL EXXON TERESSO quantity 350 cc - Interval 3000 hours		P > 37 Kw	AD 51-100

MOTOR	MAX. (Kw)		SHAFT Ø d	DIMENSIONS				BASE PLATE N°	BASEPLATE (mm)								FOUNDATION (mm)				BOLTS					
	2P	4P		H	L	LA	LB		HH	HB	HD	HL	HE	HA	L4	N° BOLTS	Weight (Kg)	F1	F2	□ N	P	Ød1 x l	m			
132 S	5.5	5.5	38	132				3		1100	700			360	400			--	1250	550				M16 x 270	60	
	7.5																									
132 M	9.2	7.5	38	132																						
160 M	11.0	11.0	42	160				300																		
	15.0	-																								
160 L	18.5	15.0	48																							
180 M	22.0	18.5	48	180																						
180 L	-	22.0	48					4		1400	1000	200	460	500	100	4	--	1550	650	120	250	M18 x 270				
200 L	30.0	30.0	55	200				320																		
	37.0																									
225 S	-	37.0	60	225				345																		
225 M	45.0	45.0	55																							
250 M	55.0	-	60	250				5	375	1550	1050	250	510	550				1700	700							

Motor:

Pump model: CN MAG-M 80-160/6x3x6

DATE:

ITEM:

PURCHASE ORDER:

CUSTOMER NAME:

OUTLINE DRAWING

CODE: D10177 Rev.:00

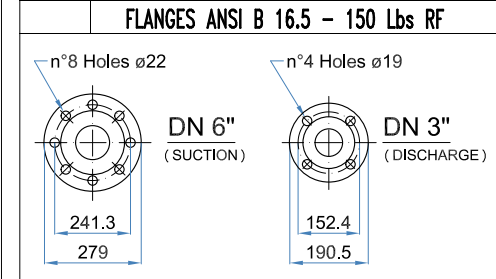
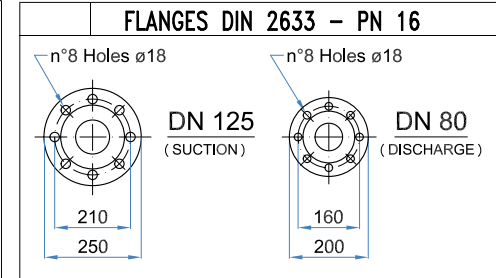
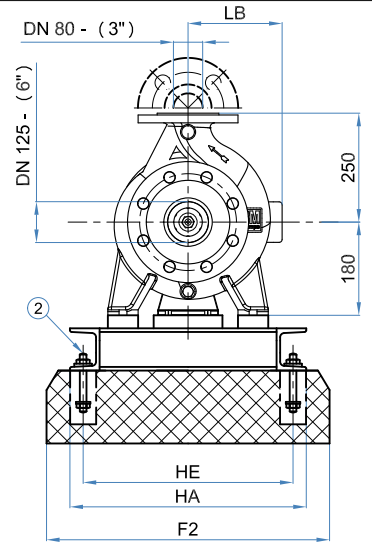
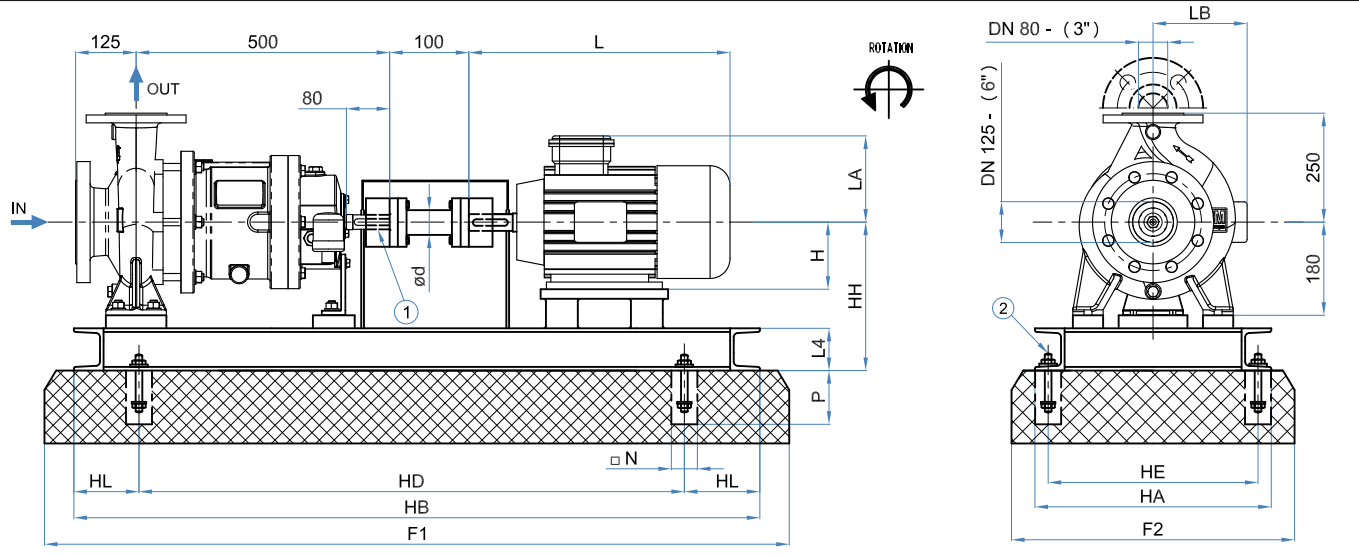

PART. 1		PART. 2		FOOT PRINT SKETCH		PUMP LUBRICATION		WEIGHT (kg)	
DIN	ANSI					STANDARD		Pump : 135	
						Ball Bearing Greased For Life Interval 20000 hours		Joint : 10 / 15	
						OPTIONAL		JOINT RU-STEEL	
						OIL EXXON TERESSO quantity 350 cc - Interval 3000 hours		P ≤37 Kw	AD 41-100
								P >37 Kw	AD 51-100

MOTOR	MAX. (Kw)		SHAFT ø d	DIMENSIONS				BASE PLATE N°	BASEPLATE (mm)								FOUNDATION (mm)				BOLTS				
	2P	4P		H	L	LA	LB		HH	HB	HD	HL	HE	HA	L4	N° BOLTS	Weight (Kg)	F1	F2	□ N	P	ød1 x l	m		
132 S	5.5		38	132				3		1100	700			360	400			--	1250	550			M16 x 270		
	7.5																								
132 M	9.2	7.5	38	132																					
160 M	11.0	11.0	42	160				300																	
	15.0	-																							
160 L	18.5	15.0	48																						
180 M	22.0	18.5	48	180																					
180 L	-	22.0	48					4		1400	1000	200	460	500	100	4	--	1550	650	120	250	M18 x 270	60		
200 L	30.0		55	200				320																	
	37.0	30.0																							
225 S	-	37.0	60	225				345																	
225 M	45.0	45.0	55																						
250 M	55.0	-	60	250				5	375	1550	1050	250	510	550				1700	700						

Motor:

Pump model: CN MAG-M 80-200/6x3x8

DATE:

ITEM:

PURCHASE ORDER:

CUSTOMER NAME:

OUTLINE DRAWING

CODE: D10182 Rev.:00

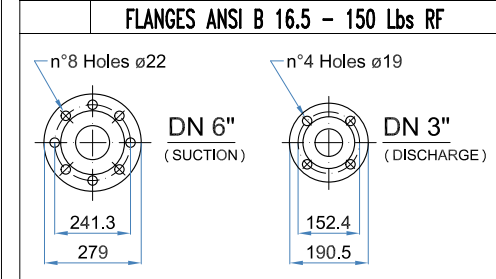
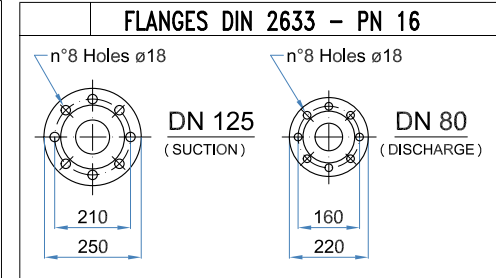
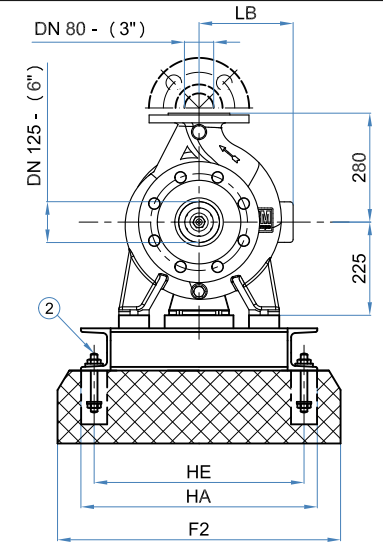
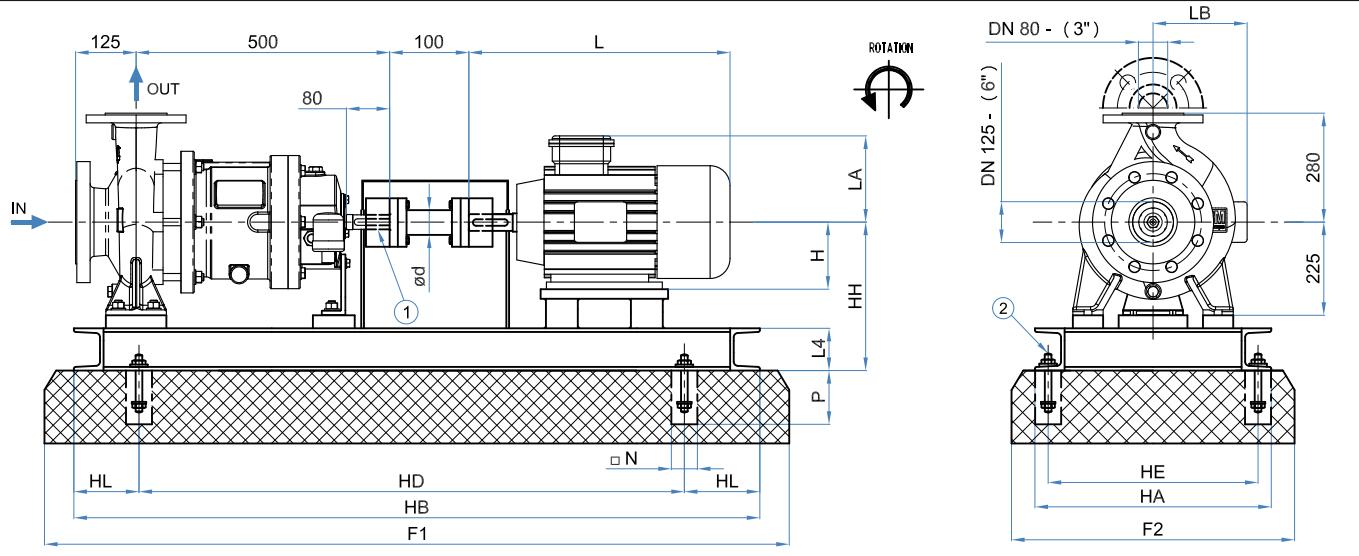

PART. 1		PART. 2		FOOT PRINT SKETCH		PUMP LUBRICATION		WEIGHT (kg)	
DIN	ANSI	<p>Top of scarf field foundation ANCHOR BOLT</p>		<p>n°4holes ø19 n°2holes ø14</p>		STANDARD Ball Bearing Greased For Life Interval 20000 hours		Pump : 145 Joint : 10 / 15	
						OPTIONAL OIL EXXON TERESSO quantity 350 cc - Interval 3000 hours		JOINT RU-STEEL P ≤37 Kw AD 41-100 P >37 Kw AD 51-100	

MOTOR	MAX. (Kw)		SHAFT ø d	DIMENSIONS				BASE PLATE N°	BASEPLATE (mm)								FOUNDATION (mm)				BOLTS					
	2P	4P		H	L	LA	LB		HH	HB	HD	HL	HE	HA	L4	N° BOLTS	Weight (Kg)	F1	F2	□ N	P	ød1 x l	m			
132 S	5.5	5.5	38	132				3		1100	700			360	400			--	1250	550				M16 x 270	60	
	7.5																									
132 M	9.2	7.5	38	132																						
160 M	11.0	11.0	42	160				4	345									--								
	15.0	-																								
160 L	18.5	15.0	48	160																						
180 M	22.0	18.5	48	180																						
180 L	-	22.0	48	180						1400	1000	200	460	500	100	4	--	1550	650	120	250	M18 x 270				
200 L	30.0	30.0	55	200				4	345									--								
	37.0																									
225 S	-	37.0	60	225																						
225 M	45.0	45.0	55	225																						
250 M	55.0	-	60	250				5	375	1550	1050	250	510	550					1700	700						

Motor:
 Pump model: CN MAG-M 80-250/6x3x10

DATE:
 ITEM:
 PURCHASE ORDER:
 CUSTOMER NAME:

OUTLINE DRAWING

CODE: D10170 Rev.:00

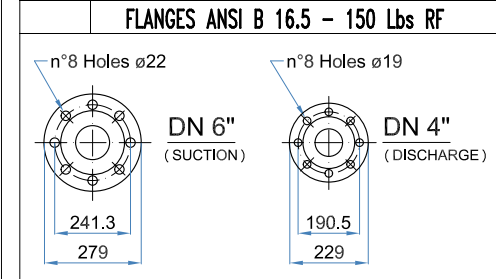
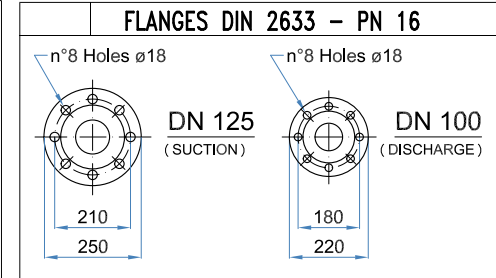
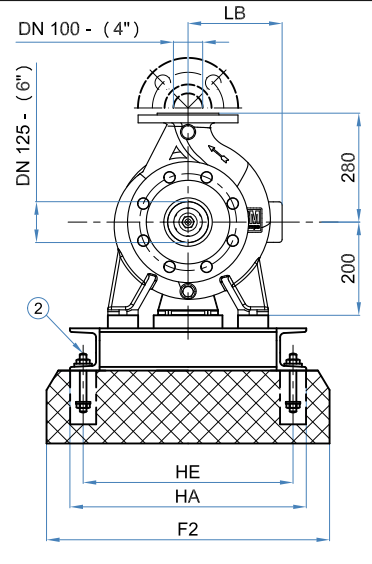
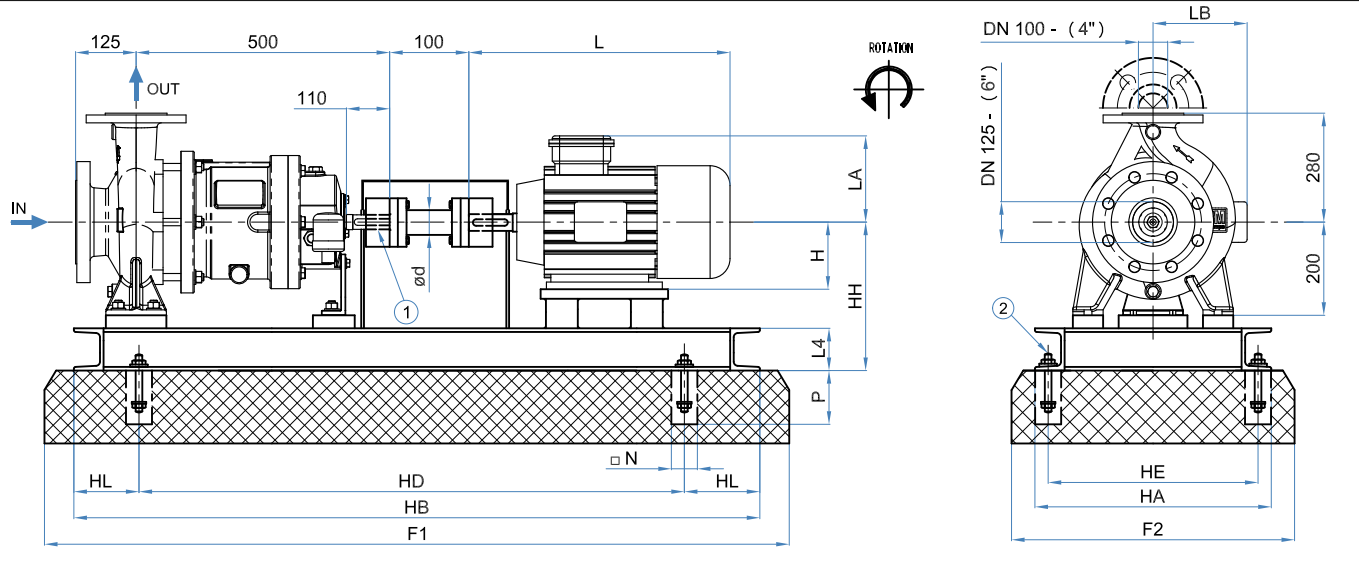

PART. 1		PART. 2		FOOT PRINT SKETCH	PUMP LUBRICATION	WEIGHT (kg)
DIN	ANSI				STANDARD	Pump : ---
					Ball Bearing Greased For Life Interval 20000 hours	Joint : ---
					OPTIONAL	
					OIL EXXON TERESSO quantity 2480 cc - Interval 3000 hours	

MOTOR	MAX. (Kw)		SHAFT Ø d	DIMENSIONS				BASE PLATE N°	BASEPLATE (mm)								FOUNDATION (mm)				BOLTS			
	2P	4P		H	L	LA	LB		HH	HB	HD	HL	HE	HA	L4	N° BOLTS	Weight (Kg)	F1	F2	□ N	P	Ød1 x l	m	
132 S	5.5	5.5	38	132				5	300	1120	740	190	440	490	80	4	--	1270	640	120	250	M20 x 270	40	
	7.5																							
132 M	9.2	7.5	38	132																				
160 M	11.0	11.0	42	160				6	320	1250	840	205	490	540	100	4	--	1400	690	120	250	M20 x 270	40	
	15.0	-																						
160 L	18.5	15.0	48	180																				
180 M	22.0	18.5	48	180																				
180 L	-	22.0	48	180																				
200 L	30.0	30.0	55	200				7	345	1400	940	230	550	610	100	4	--	1550	760	120	250	M24 x 270	40	
	37.0																							
225 S	-	37.0	60	225																				
225 M	45.0	45.0	55	225																				
250 M	55.0	-	60	250				8	370	1600	1060	270	600	660	100	4	--	1750	810	120	250	M24 x 270		

Motor:

Pump model: CN MAG-M 100-200/6x4x8

DATE:

ITEM:

PURCHASE ORDER:

CUSTOMER NAME:

OUTLINE DRAWING

CODE: D10207 Rev.:00

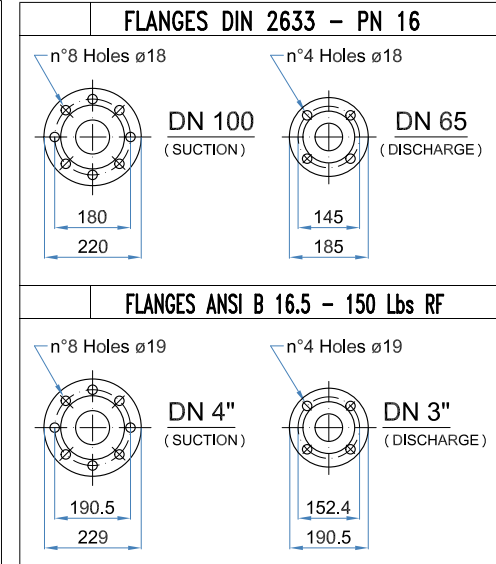
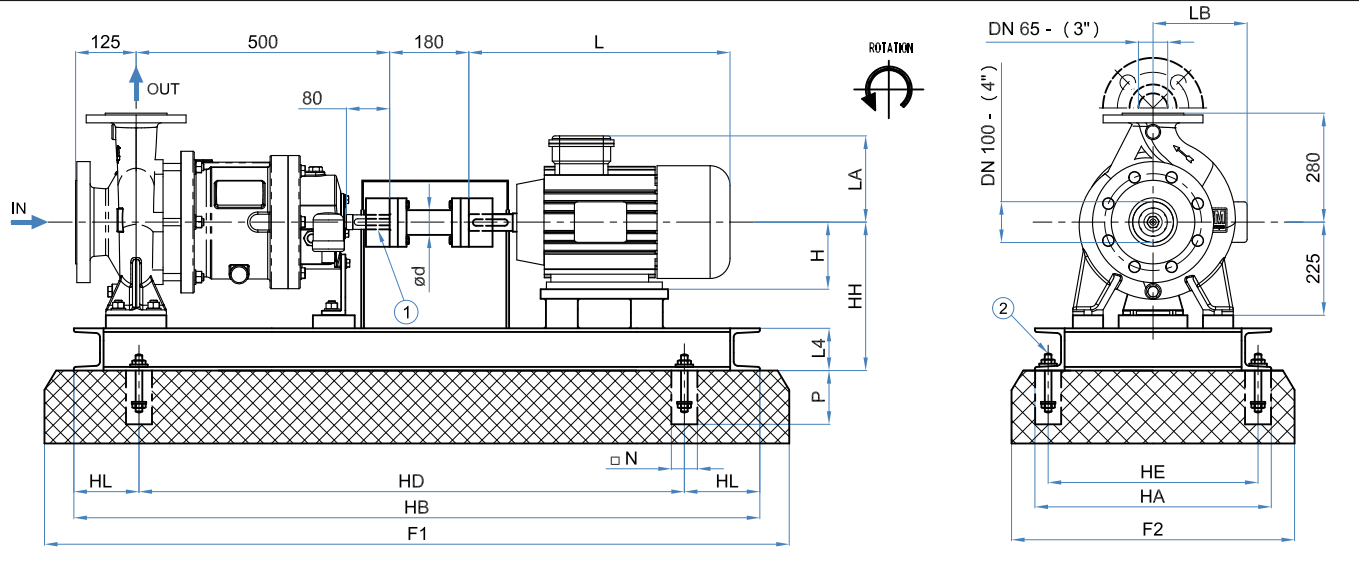

PART. 1		PART. 2		FOOT PRINT SKETCH		PUMP LUBRICATION		WEIGHT (kg)	
DIN	ANSI		Top of scarf field foundation ANCHOR BOLT		n°4holes ø14 n°2holes ø14	STANDARD	Pump : 170	Joint : 10 / 15	
						Ball Bearing Greased For Life Interval 20000 hours	JOINT RU-STEEL		
						OPTIONAL	P ≤37 Kw AD 41-100		
						OIL EXXON TERESSO quantity 350 cc - Interval 3000 hours	P >37 Kw AD 51-100		

MOTOR	MAX. (Kw)		SHAFT ø d	DIMENSIONS				BASE PLATE N°	BASEPLATE (mm)								FOUNDATION (mm)				BOLTS				
	2P	4P		H	L	LA	LB		HH	HB	HD	HL	HE	HA	L4	N° BOLTS	Weight (Kg)	F1	F2	□ N	P	ød1 x l	m		
132 S	5.5		38	132				3		1100	700			360	400			--	1250	550			M16 x 270		
	7.5																								
132 M	9.2	7.5	38	132																					
160 M	11.0	11.0	42	160				300																	
	15.0	-																							
160 L	18.5	15.0	48																						
180 M	22.0	18.5	48																						
180 L	-	22.0	48					4		1400	1000	200	460	500	100	4	--	1550	650	120	250	M18 x 270			
200 L	30.0		55	200				320																	
	37.0	30.0																							
225 S	-	37.0	60					345																	
225 M	45.0	45.0	55																						
250 M	55.0	-	60	250				5	375	1550	1050	250	510	550				1700	700						

Motor:

Pump model: CN MAG-M 65-315/4x3x13

DATE:

ITEM:

PURCHASE ORDER:

CUSTOMER NAME:

OUTLINE DRAWING

CODE: D10353 Rev.:00

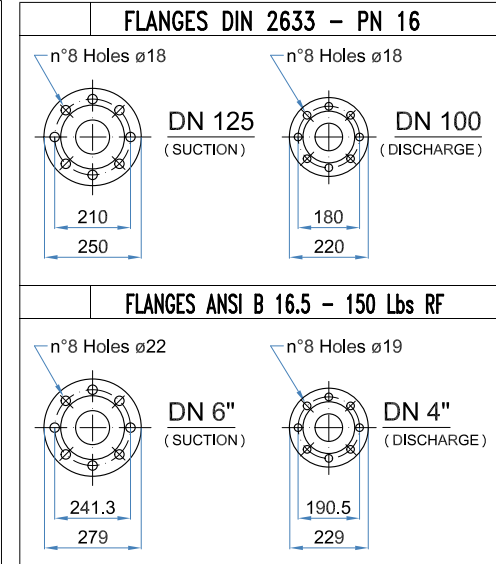
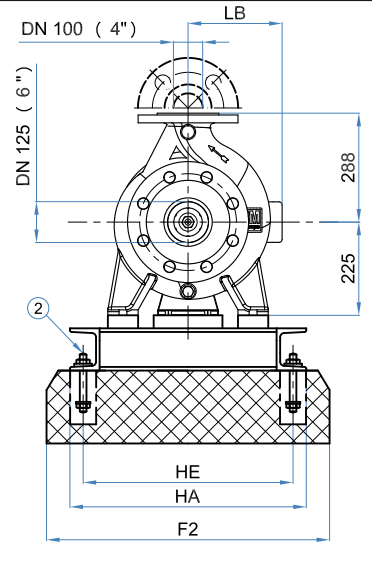
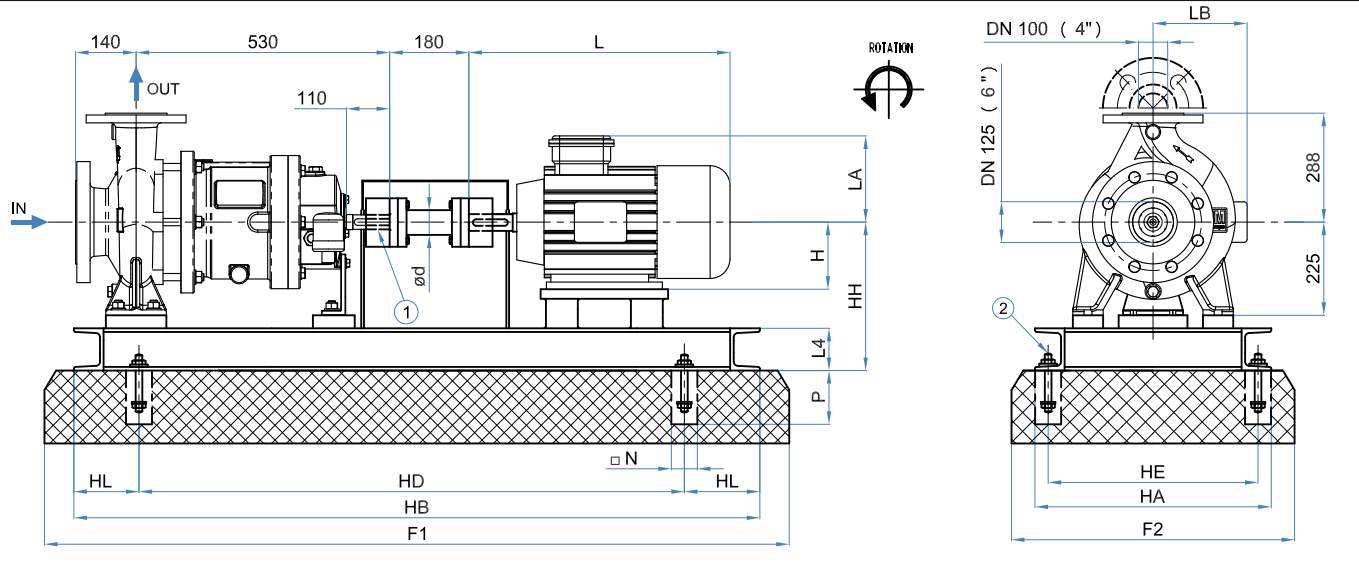

PART. 1		PART. 2		FOOT PRINT SKETCH		PUMP LUBRICATION		WEIGHT (kg)	
DIN	ANSI		Top of scarf field foundation ANCHOR BOLT		STANDARD	Pump : --- Joint :		JOINT RU-STEEL	
					Ball Bearing Greased For Life Interval 20000 hours	P ≤37 Kw AD 41-100		P >37 Kw AD 51-100	
					OPTIONAL	OIL EXXON TERESSO quantity 350 cc - Interval 3000 hours			

MOTOR	MAX. (Kw)		SHAFT ø d	DIMENSIONS				BASE PLATE N°	BASEPLATE (mm)								FOUNDATION (mm)				BOLTS				
	2P	4P		H	L	LA	LB		HH	HB	HD	HL	HE	HA	L4	N° BOLTS	Weight (Kg)	F1	F2	□ N	P	ød1 x l	m		
160 M	11.0	11.0	42	160																					
	15.0	-																							
160 L	18.5	15.0	48																						
180 M	22.0	18.5	48	180				4	320	1400	1000	200	460	500	100										
180 L	-	22.0	48																						
200 L	30.0	-	55	200																					
	37.0	30.0																							
225 S	-	37.0	60	225																					
225 M	45.0	45.0	55																						
250 M	55.0	-	60	250				5	375	1550	1050	250	510	550											
280 S	75.0	-	65	280				--	470	1800	1200	300	670	730	160										M20 x 270

Motor:
Pump model: CN MAG-M 100-250/6x4x10

DATE:
ITEM:
PURCHASE ORDER:
CUSTOMER NAME:

OUTLINE DRAWING

CODE: D10413 Rev.:00

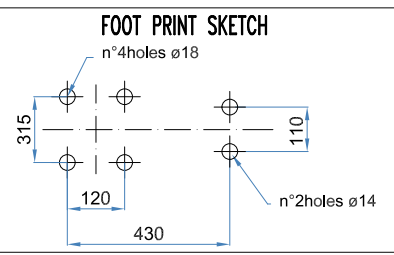
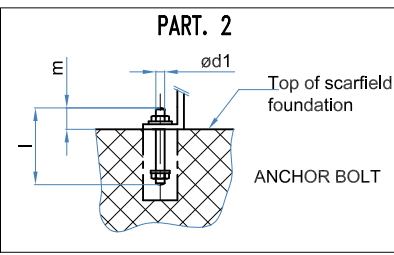
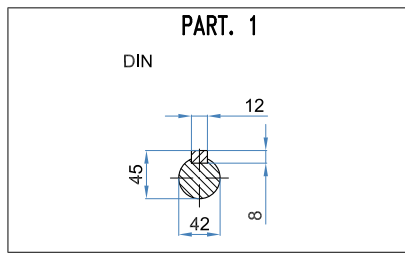
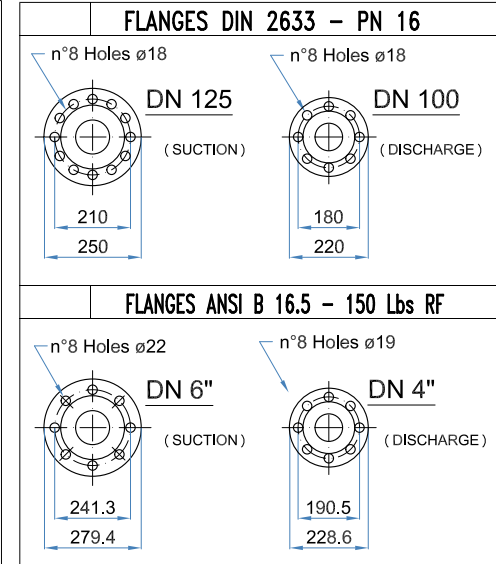
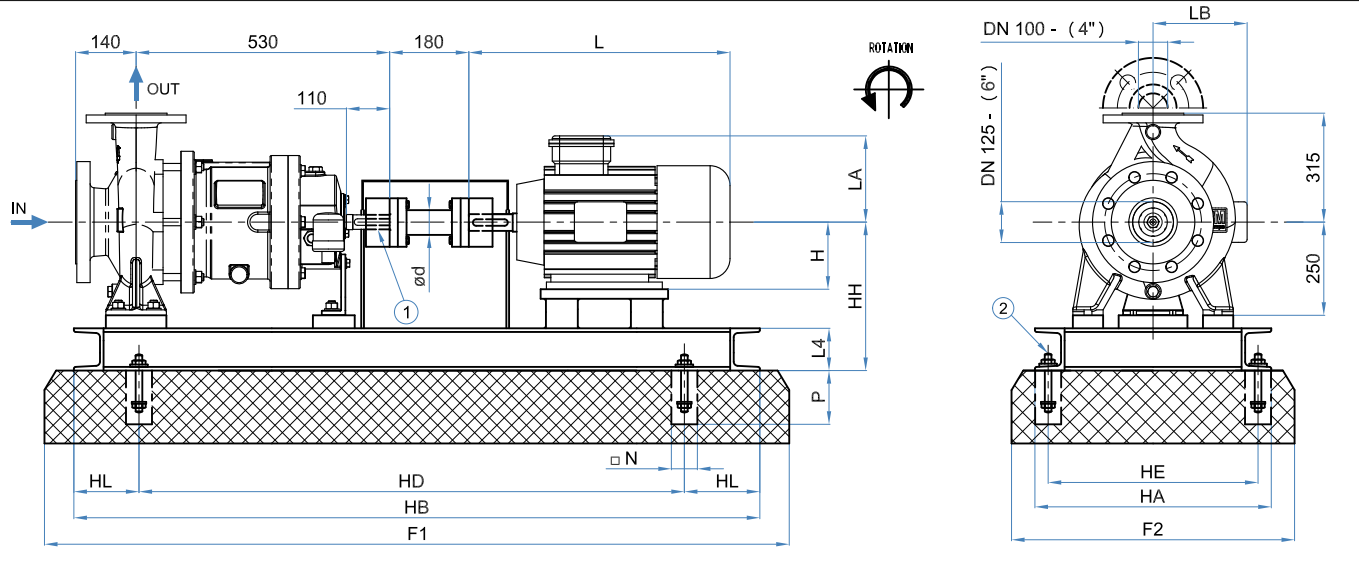

PUMP LUBRICATION

STANDARD

Ball Bearing Greased For Life Interval 20000 hours

OPTIONAL

OIL EXXON TERESSO quantity 350 cc - Interval 3000 hours

WEIGHT (kg)

Pump :

Joint :

JOINT RU-STEEL

P ≤37 Kw AD 41-100

P >37 Kw AD 51-100

Motor:

Pump model: CN MAG-M 100-315/8x6x13

MOTOR	MAX. (Kw)		SHAFT ø d	DIMENSIONS				BASE PLATE N°	BASEPLATE (mm)								FOUNDATION (mm)				BOLTS		
	2P	4P		H	L	LA	LB		HH	HB	HD	HL	HE	HA	L4	N° BOLTS	Weight (Kg)	F1	F2	□ N	P	ød1 x l	m
180	-	22	48	180				9	430	1800	1200	300	670	730	160	4	--	2000	900	150	300	M24 x 320	60
200 L	-	30	55	200																			
225 S	-	37	60	225																			
225 M	-	45																					
280 S	75	-	65	280				10	465	1800	1200	300	670	730	160	4	--	2000	900	150	300	M24 x 320	60
315 M	132	-	65	315				11	500	2100	1500	300	740	800	160	4	--	2300	1000	150	300	M24 x 320	60
315 M	-	132	80																				

DATE:

ITEM:

PURCHASE ORDER:

CUSTOMER NAME:

OUTLINE DRAWING

CODE: D11104 Rev.:01

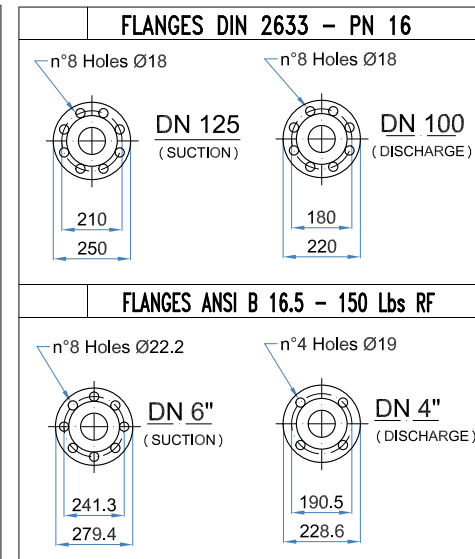
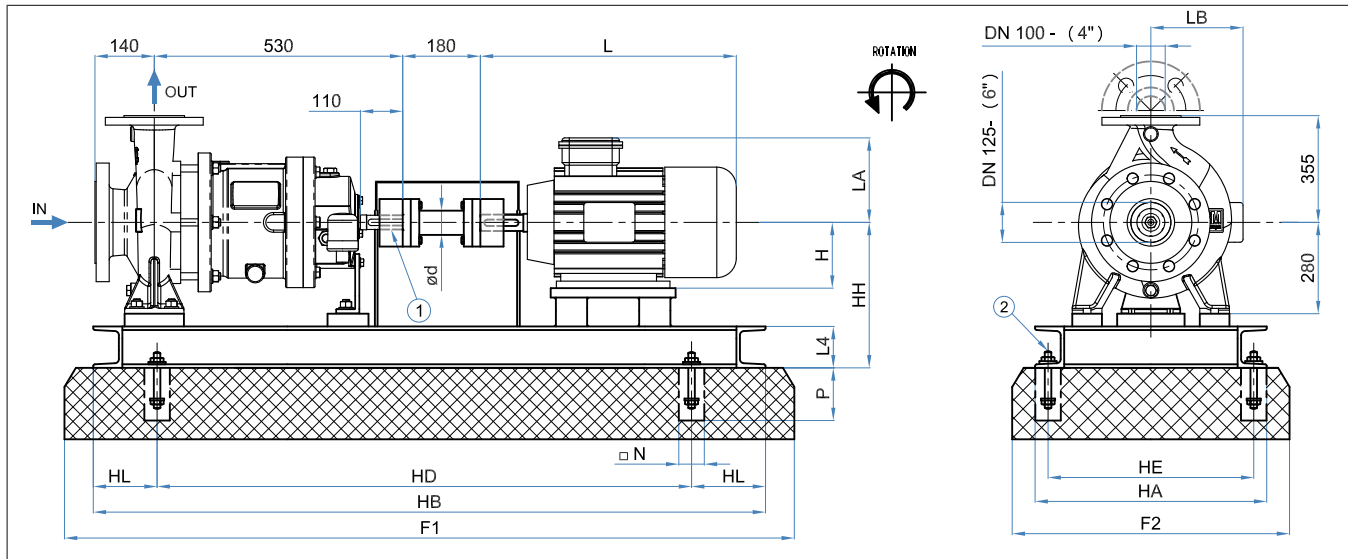

PART. 1	PART. 2	FOOT PRINT SKETCH	PUMP LUBRICATION	WEIGHT (kg)
DIN 	 Top of scarf field foundation ANCHOR BOLT		STANDARD Ball Bearing Greased For Life Interval 20000 hours	Pump : 270 Joint : 10 / 15
			OPTIONAL OIL	JOINT RU-STEEL AD 71 - 180

MOTOR	MAX. (Kw)		SHAFT Ø d	DIMENSIONS				BASE PLATE N°	BASEPLATE (mm)								FOUNDATION (mm)				BOLTS			
	2P	4P		H	L	LA	LB		HH	HB	HD	HL	HE	HA	L4	N° BOLTS	Weight (Kg)	F1	F2	□ N	P	Ød1 x l	m	
200		30	55	200					430	1800	1200	300	670	730	160	4	-	2000	900	150	300	M24 x 320	60	
225 S		37	60	225					430	2000	1400	300	670	730	160	4	-	2400	900	150	300	M24 x 320	60	
225 M		45																						
250		55	65	250																				

Motor:

Pump model: CN MAC-M 100-400/6x4x16

CUSTOMER NAME:

PURCHASE ORDER:

DATE:

ITEM:

OUTLINE DRAWING

CODE: D10414 Rev.:00

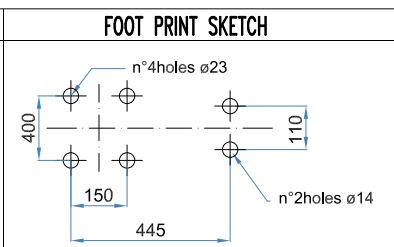
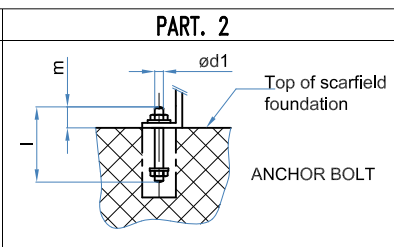
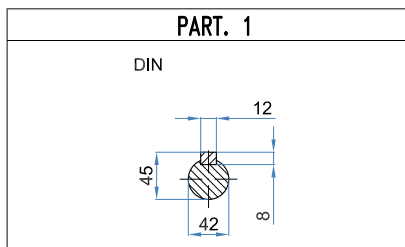
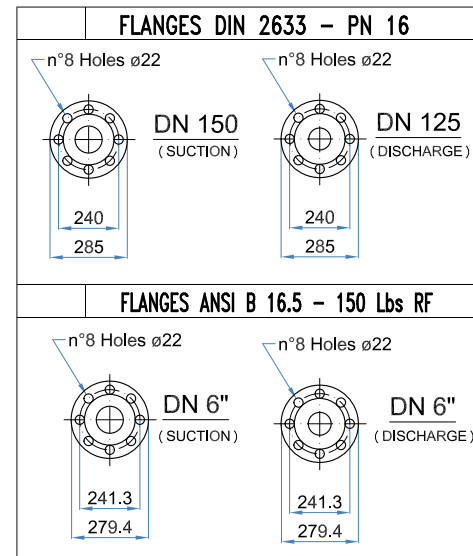
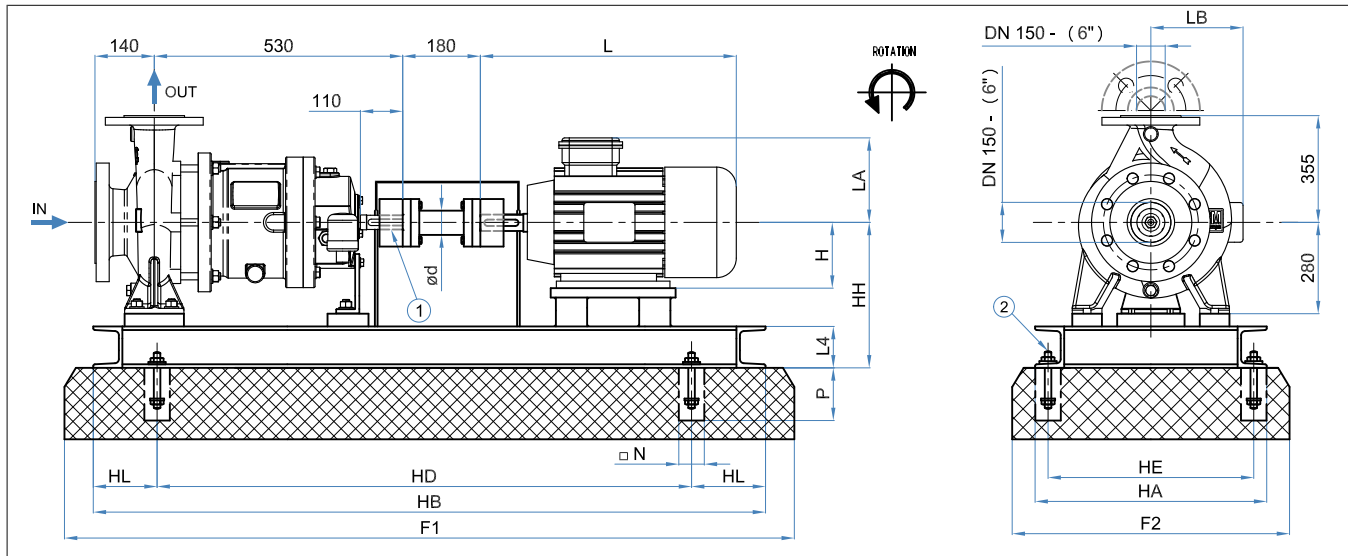

PUMP LUBRICATION

STANDARD
Ball Bearing Greased For Life Interval 20000 hours
OPTIONAL
OIL EXXON TERESSO quantity 350 cc - Interval 3000 hours

WEIGHT (kg)

Pump : 270	
Joint : 10 / 15	
JOINT RU-STEEL	
P ≤37 Kw AD 41-100	
P >37 Kw AD 51-100	

MOTOR	MAX. (Kw)		SHAFT Ø d	DIMENSIONS				BASE PLATE N°	BASEPLATE (mm)								FOUNDATION (mm)				BOLTS		
	2P	4P		H	L	LA	LB		HH	HB	HD	HL	HE	HA	L4	N° BOLTS	Weight (Kg)	F1	F2	□ N	P	Ød1 x l	m
180	-	22	48	180				9	310	1800	1200	300	670	730	160	4	--	2000	900	150	300	M24 x 320	60
200 L	-	30	55	200																			
225 S	-	37	60	225																			
225 M	-	45																					

MOTOR:

DATE:

ITEM:

PURCHASE ORDER:

CUSTOMER NAME:

Pump model: CN MAG-M 125-315/6x6x15

OUTLINE DRAWING

CODE: D10209 Rev.:00

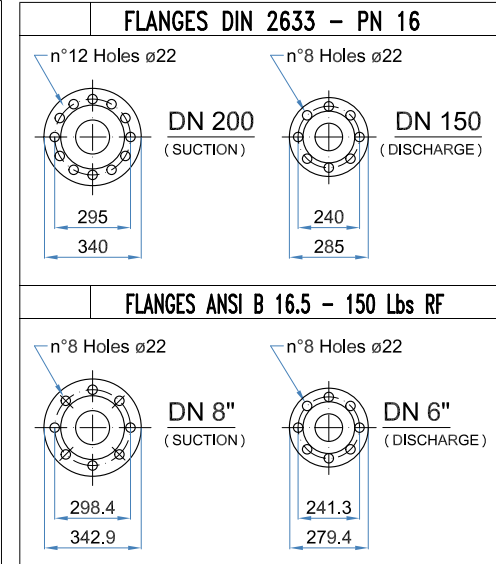
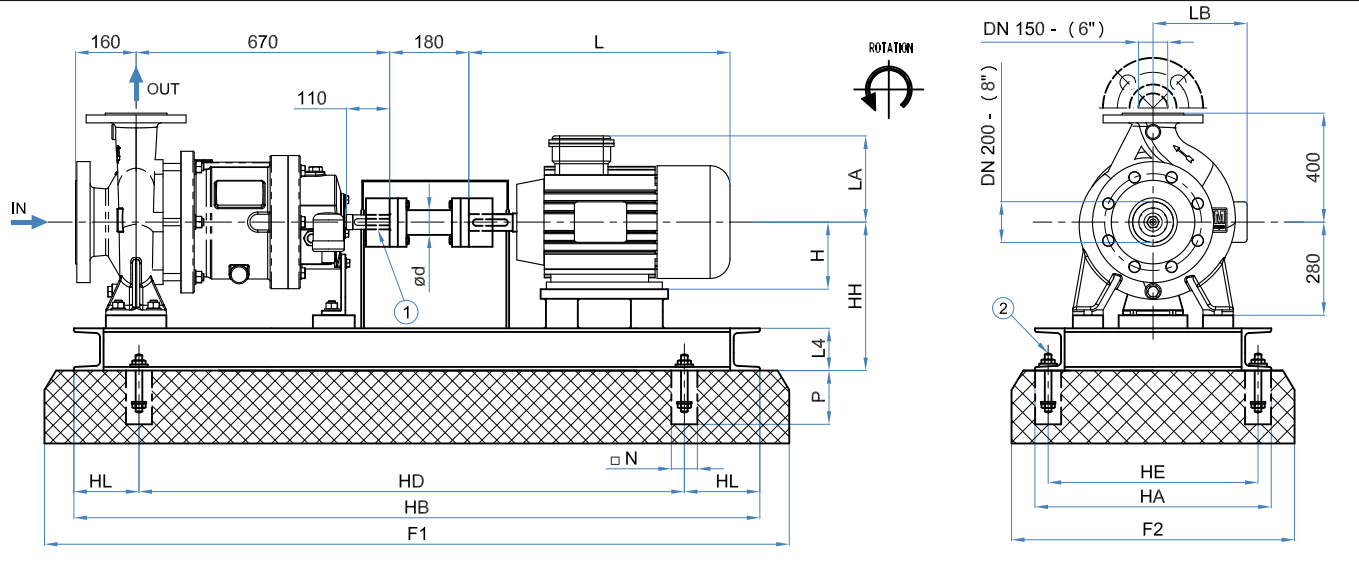

PART. 1		PART. 2		FOOT PRINT SKETCH		PUMP LUBRICATION		WEIGHT (kg)	
DIN	ANSI			STANDARD	Pump : 270		Joint : 10 / 15		
				Ball Bearing Greased For Life Interval 20000 hours	JOINT RU-STEEL		P ≤37 Kw AD 41-100		
				OPTIONAL	P >37 Kw AD 51-100				
				OIL EXXON TERESSO quantity 350 cc - Interval 3000 hours					

Motor:

Pump model: CN MAG-M 150-315/8x6x13

MOTOR	MAX. (Kw)		SHAFT Ø d	DIMENSIONS				BASE PLATE N°	BASEPLATE (mm)								FOUNDATION (mm)				BOLTS		
	2P	4P		H	L	LA	LB		HH	HB	HD	HL	HE	HA	L4	N° BOLTS	Weight (Kg)	F1	F2	□ N	P	Ød1 x l	m
180	-	22	48	180				9	310	1800	1200	300	670	730	160	4	--	2000	900	150	300	M24 x 320	60
200 L	-	30	55	200																			
225 S	-	37	60	225																			
225 M	-	45	60	225				10	335	2100	1500	300	740	800	160	4	--	2300	1000	150	300	M24 x 320	60
250 M	-	55	65	250																			
280 S	-	75	75	280																			
280 M	-	90	75	280																			
315 M	-	110	80	315																			

DATE:

ITEM:

PURCHASE ORDER:

CUSTOMER NAME:

OUTLINE DRAWING

CODE: D10597 Rev.:00

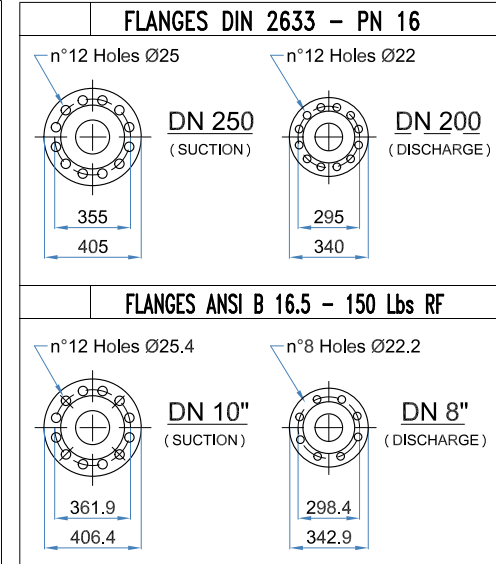
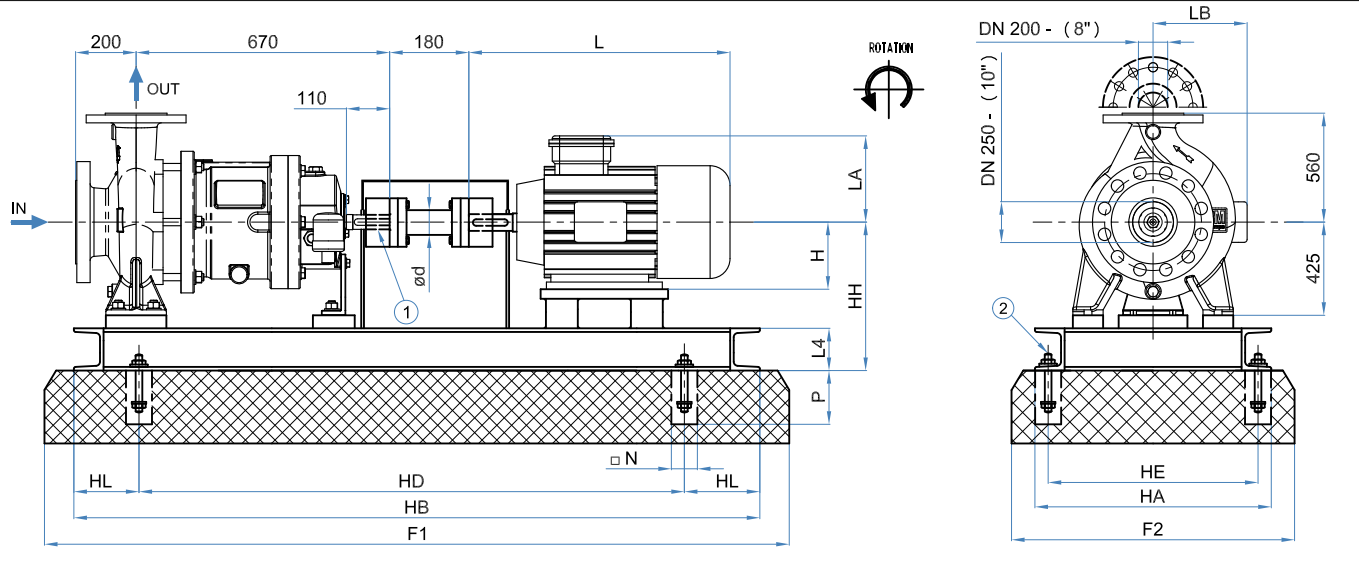

PART. 1		PART. 2		FOOT PRINT SKETCH		PUMP LUBRICATION		WEIGHT (kg)	
DIN			ANCHOR BOLT		n°4holes Ø25	STANDARD	Pump : ---	---	---
						Ball Bearing Greased For Life Interval 20000 hours	Joint : ---		
OIL	EXXON TERESSO	quantity 2480 cc - Interval 3000 hours	---	---	n°2holes ø18	OPTIONAL	---	---	---
						---	---		

MOTOR	MAX. (Kw)		SHAFT	DIMENSIONS				BASE PLATE	BASEPLATE (mm)								FOUNDATION (mm)				BOLTS				
	4P	-		Ø d	H	L	LA		LB	N°	HH	HB	HD	HL	HE	HA	L4	N° BOLTS	Weight (Kg)	F1	F2	□ N	P	Ød1 x l	m
280M	90		75	280				11	710	2100	1500	300	670	750	260	4	--	2300	950	150	300	M24 x 320	60		
355	355		95	355				13	760	2700	2100	300	750	930	260	4	--	2900	950	150	300	M24 x 320	60		

